

PROJECT NAME: \_\_\_\_\_

ROOF REPLACEMENT AT:  
**MERIDEN YMCA**

110 WEST MAIN STREET  
MERIDEN, CONNECTICUT 06451

PROJECT LOCATION: \_\_\_\_\_

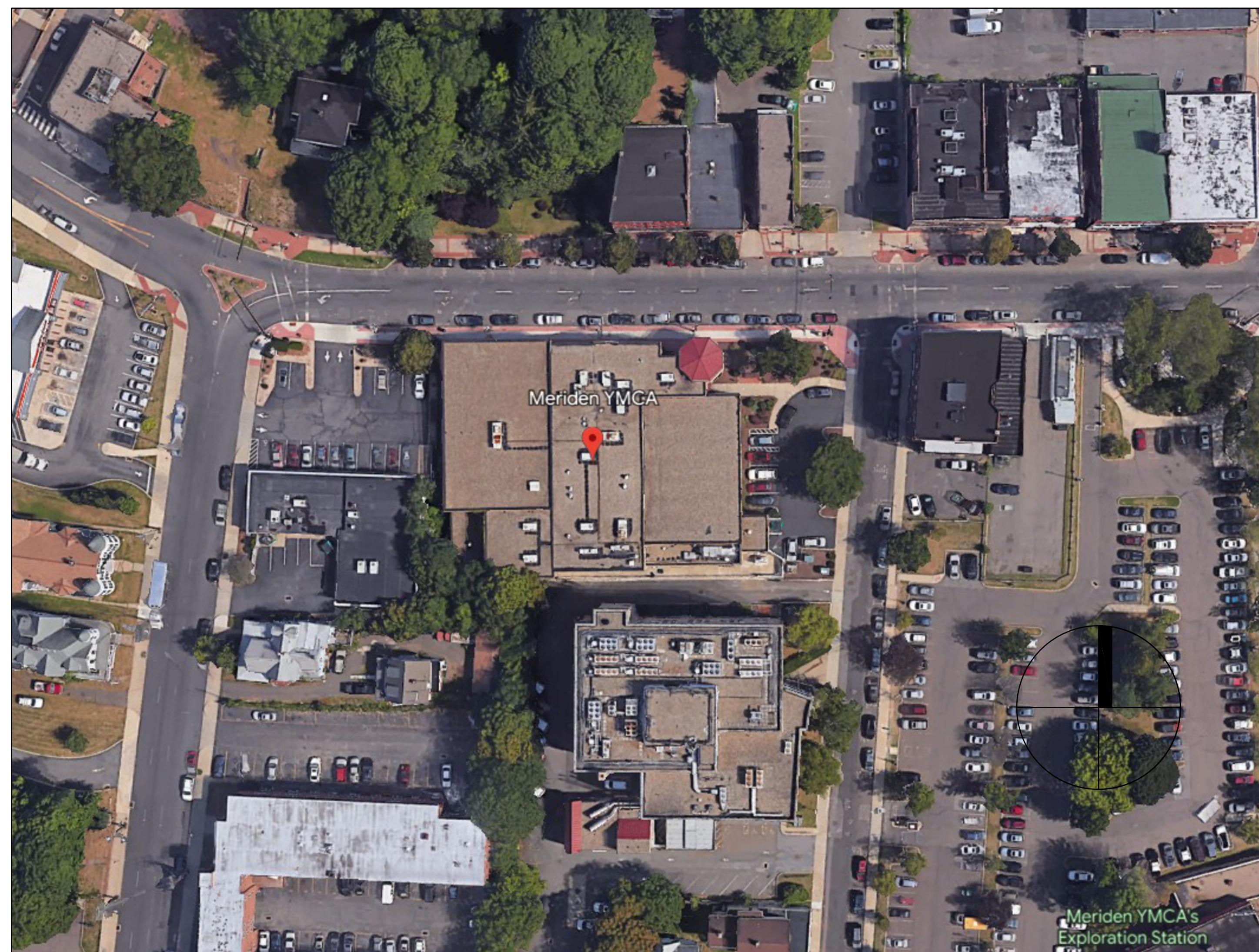

DRAWING LIST

COVER SHEET

ARCHITECTURAL:

- A1 OVERALL ROOF PLAN
- A2 ROOF DETAILS

ARCHITECT

SILVER PETRUCELLI & ASSOC.  
3190 WHITNEY AVENUE, HAMDEN CT 06518  
311 STATE STREET NEW LONDON, CT 06320  
PHONE 203 230 9007 silverpetrucelli.com



SILVER PETRUCELLI + ASSOCIATES

3190 WHITNEY AVENUE HAMDEN CT 06518  
311 STATE STREET NEW LONDON CT 06320  
203 230 9007 silverpetrucelli.com

CONSTRUCTION DOCUMENT SUBMISSION 05/23/2023



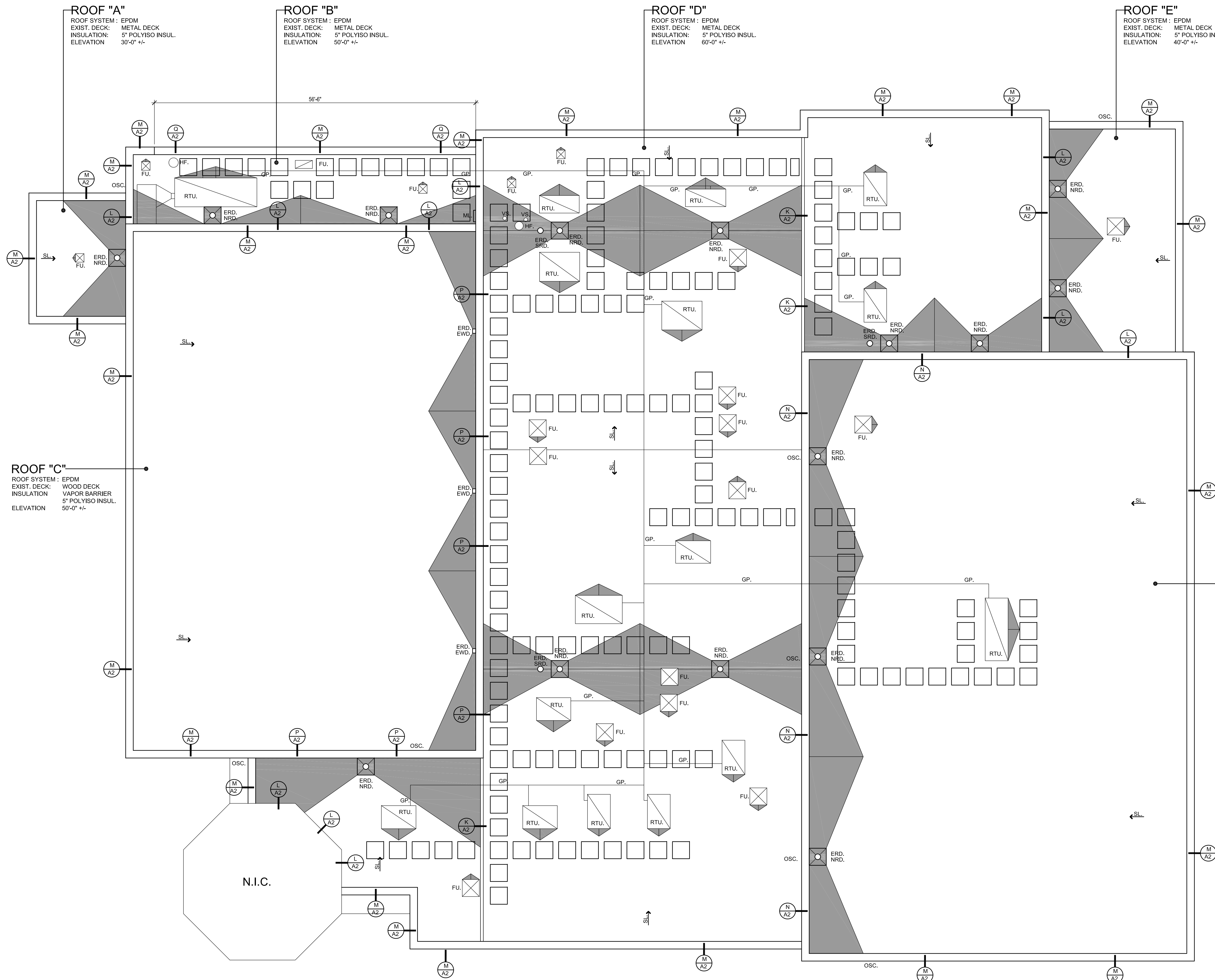

### SYMBOL LEGEND

- PLAN SECTION DETAIL OR ELEVATION - SHEET NUMBER
- INDICATES SLOPE DIRECTION OF TAPERED INSULATION AT 1/2" PER FOOT
- TAPERED INSULATION CRICKET SLOPED @ 1/2" PER FOOT
- INDICATES SLOPE DIRECTION & INDICATES EXISTING ROOF PITCH.
- NOT IN CONTRACT SCOPE
- WALKWAY PADS. SEE CONSTRUCTION NOTE #2
- EXISTING ROOF DRAIN TO BE REMOVED. SEE DEMOLITION NOTES.
- NEW ROOF DRAIN TO BE INSTALLED. SEE DETAIL A/A2
- SECONDARY OVERFLOW ROOF DRAIN. SEE DETAIL B/A2
- END WALL DRAIN. SEE DETAIL C/A2
- EMERGENCY OVERFLOW SCUPPER. SEE DETAIL D/A2
- EXISTING VENT STACK. SEE DETAIL E/A2
- EXISTING HOT FLUE. SEE DETAIL F/A2
- EXISTING FAN UNIT. SEE DETAIL G/A2
- EXISTING ROOF TOP MECHANICAL UNIT SEE DETAIL H/A2
- EXISTING GAS PIPING TO REMAIN. SEE CONSTRUCTION NOTE #3
- EXISTING METAL LADDER TO REMAIN.

- ### GENERAL NOTES
1. ALL FLAT ROOFS TO RECEIVE 5" RIGID INSULATION MINIMUM UNLESS OTHERWISE NOTED.
  2. FIELD VERIFY ALL DIMENSIONS & PERFORM TEST CUTS AT EACH ROOF PRIOR TO THE BID.
  3. ALL MATERIALS ARE NEW UNLESS OTHERWISE NOTED "EXISTING".
  4. ALL WOOD BLOCKING, PLYWOOD & NAILERS TO BE PRESSURE TREATED, (P.T.)
  5. ALL WOOD BLOCKING INDICATED IN DETAILS ARE TO BE ANCHORED TO THE EXISTING STRUCTURE.
  6. ALL MEMBRANE FLASHING INDICATED IS TO EXTEND A MINIMUM OF 6". (VERTICAL OR HORIZONTAL)
  7. CONTRACTOR IS TO SURVEY THE EXISTING ROOF DECKS W/IA LEVEL (AFTER DEMOLITION) TO VERIFY THE SLOPES INDICATED ON PLAN ARE ACCURATE. NOTIFY ARCHITECT IMMEDIATELY OF ANY DISCREPANCIES PRIOR TO PERFORMING ANY ADDITIONAL ROOFING OPERATIONS.
  8. CONTRACTOR IS TO INSPECT THE UNDERSIDE OF ALL ROOF DECKS PRIOR TO ROOFING OPERATIONS TO ENSURE THAT NO INTERIOR MATERIALS, EQUIPMENT, FINISHES OR OBJECTS WILL BE PIERCED OR DAMAGED.
  9. CONTRACTOR ASSUMES ALL RESPONSIBILITY DURING PROJECT & WILL REPLACE ANY & ALL DAMAGED EQUIPMENT W/NO ADDITIONAL COST TO OWNER.
  10. SITE AREAS DISTURBED SHALL BE CLEANED & RE-LEVELLED. W/LAWN AREAS MAGNETICALLY RAKED TO REMOVE ANY METAL DEBRIS & RE-SEEDED AS REQUIRED TO MATCH ADJACENT CONDITIONS.
  11. CONTRACTOR ASSUMES ALL RESPONSIBILITY FOR CLEAN UP OF ROOFING MATERIALS & DEBRIS THAT PENETRATES THE INTERIOR ENVELOPE OF THE BUILDING W/NO ADDITIONAL COST TO THE OWNER.
  12. SNAKE/CLEAN OUT ALL EXISTING VERTICAL & HORIZONTAL LEADERS OUT TO NEAREST CRICKETS AROUND EXIST. HVAC UNITS AS REQUIRED TO AVOID PONDING.
  13. ALL CRICKETS ARE TO BE SLOPED @ A MINIMUM OF 1/2" PER FOOT & COORDINATE CRICKETS AROUND EXIST. HVAC UNITS AS REQUIRED TO AVOID PONDING.
  14. CONTRACTOR IS RESPONSIBLE FOR THE REMOVAL & RE-INSTALLATION OF ALL HVAC UNITS INCLUDING ANY ELECTRICAL OR MECHANICAL CONNECTIONS. THIS MAY INCLUDE THE EXTENSION OF EXISTING ELECTRICAL & DUCTWORK SYSTEMS TO ACCOMMODATE NEW MECHANICAL UNIT CURBING & NEW ROOFING SYSTEM.
  15. SNAKE/CLEAN OUT ALL EXISTING VENT STACKS BEFORE THE INSTALLATION OF METAL SLEEVE.
  16. ALL DRAIN PIPING IS INSULATED ABOVE THE CEILINGS. THE EXACT ROUTE WILL BE DETERMINED IN THE FIELD. MAKE MINOR ADJUSTMENT IN THE ROUTE AT NO ADDITIONAL COST TO OWNER.
  17. NEW ROOF INSULATION TO BE A MINIMUM OF R-30 AT ALL NEW ROOF DRAINS AND/OR THE LOW POINTS OF THE ROOF AREAS.
  18. ALL ANTENNAE, CONDUITS & ANY OTHER OBJECTS TO REMAIN AFFECTED BY SCOPE OF WORK, TO BE REMOVED & REINSTALLED.

- ### DEMOLITION NOTES
1. REMOVE EXISTING FLAT METAL ROOFING SYSTEM.
  2. REMOVE ALL PERIMETER METAL FLASHING WITHIN SCOPE OF WORK.
  3. REMOVE EXISTING ROOF DRAINS & SUMP.
  4. REMOVE & DISPOSE OF EXISTING SAFETY WIRE.

- ### CONSTRUCTION NOTES
1. CONTRACTOR TO PROVIDE A SPECIFIED QUANTITY OF EXISTING DECK REPAIR & REPLACEMENT. SEE PROJECT MANUAL.
  2. WALKWAY PADS TO BE INSTALLED PER MANUFACTURER'S RECOMMENDATION. SEE PROJECT MANUAL FOR ADDITIONAL INFORMATION. COORDINATE & FINALIZE EXACT ROUTE W/ OWNER & ARCHITECT.
  3. EXISTING GAS PIPING TO REMAIN. SCRAPER, PRIME & PAINT ALL EXPOSED GAS PIPING. SEE DETAIL J/A2 & PROJECT MANUAL.

ROOF AREAS		ROOF ASSEMBLY	
ROOF "A"	400 SF.	ROOF "D"	10,780 SF.
ROOF "B"	940 SF.	ROOF "E"	1,000 SF.
ROOF "C"	5,900 SF.	ROOF "F"	7,400 SF.
TOTAL ROOF AREAS: 28,420 SF.			
THIS AREA IS APPROXIMATE - V.I.F.			
IECC CODE REQUIREMENT R-VALUE MIN. R-30			
CONNECTICUT ZONE 2B			
CBCS REQUIREMENT : R-30 - U.0333			
OUTSIDE AIR	0.17	ROOF MEMBRANE	0.33
COVERBOARD	2.20	5" POLYISO INSUL.	29.7
EXISTING DECK	1.23	INSIDE AIR	0.61
R-VALUE TOTAL		34.24	

### CODE INFORMATION

USE GROUP : B  
 CONSTRUCTION CLASS: 2B  
 RISK CATEGORY 4B  
 ULTIMATE DESIGN WIND SPEED: 135 MPH  
 NOMINAL DESIGN WIND SPEED: 105 MPH

FACTORY MUTUAL ENGINEERING & RESEARCH CORPORATION (FM) - ROOF ASSEMBLY CLASSIFICATION OF NON-COMBUSTIBLE CONSTRUCTION. WIND UPLIFT REQUIREMENT OF 160 FOR FIELD, 175 FOR PERIMETER AND 1-110 FOR CORNERS. IN ACCORDANCE WITH FM PROPERTY LOSS PREVENTION DATA SHEETS 1-28.

1 OVERALL ROOF PLAN  
 1/8"=1'-0"

Project Title:  
**ROOF REPLACEMENT AT:  
 MERIDEN YMCA**  
 110 WEST MAIN STREET  
 MERIDEN, CONNECTICUT 06451



**SILVER PETRUCELLI + ASSOCIATES**  
 3190 WHITNEY AVENUE HAMDEN CT 06518  
 311 STATE STREET NEW LONDON CT 06320  
 203 230 9007 silverpetrucelli.com

Revision:	Description:	Date:	Revised By:

Drawing Title: **OVERALL ROOF PLAN**

Date: 05/23/2023  
 Scale: 1/8"=1'-0"  
 Drawn By: K.LINSLEY  
 Project Number: 23.024

Drawing Number: **A1**

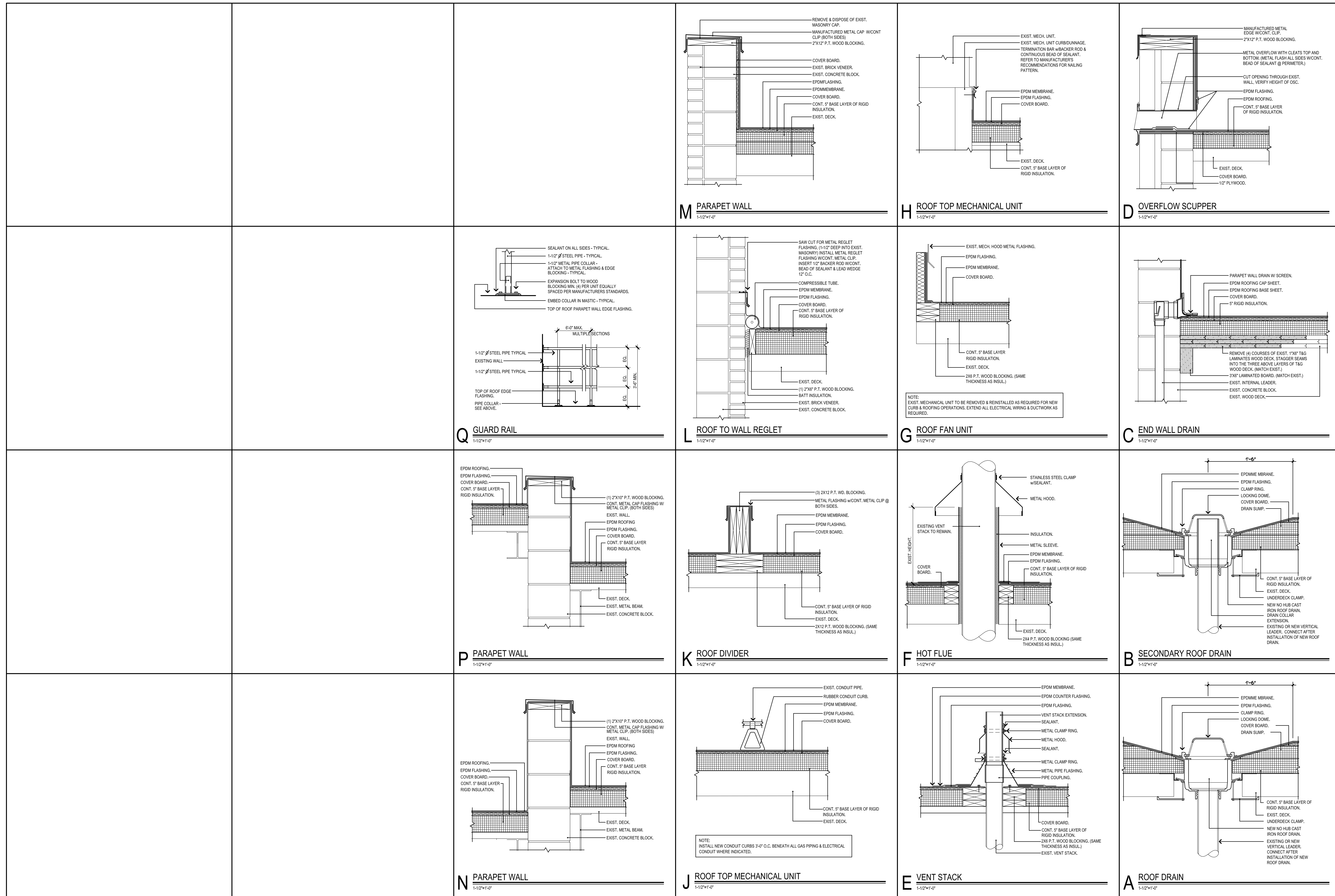

Revision:	Description:	Date:	Revised By: