

TENNIS COURT RECONSTRUCTION COLUMBUS PARK

LEWIS AVENUE
MERIDEN, CONNECTICUT



HON. ANGELO R. D'AGOSTINO, MAYOR

CITY COUNCIL

ANNA P. NEUMON
DEPUTY MAYOR

EMIL A. ALTABELLO, JR.
MAJORITY LEADER

JAMES F. BELOTE
MINORITY LEADER

WILLIAM A. COOK

LAUREN COFFEY-FRANCO

LAWRENCE J. KIBNER

JUDITH M. NILAND

JAMES L. PELLEGRINO

MICHAEL S. ROHDE

WALTER SHAMOCK

ANTHONY D. TOMASSETTI

MARK G. ZEBORA
DIRECTOR
PARKS AND RECREATION

RECOMMENDED BY: 
JOSEPH A. FRANCO, P.E.
DIRECTOR OF PUBLIC WORKS
AND CITY ENGINEER

APPROVED BY: 
MICHAEL ALDI
CITY MANAGER

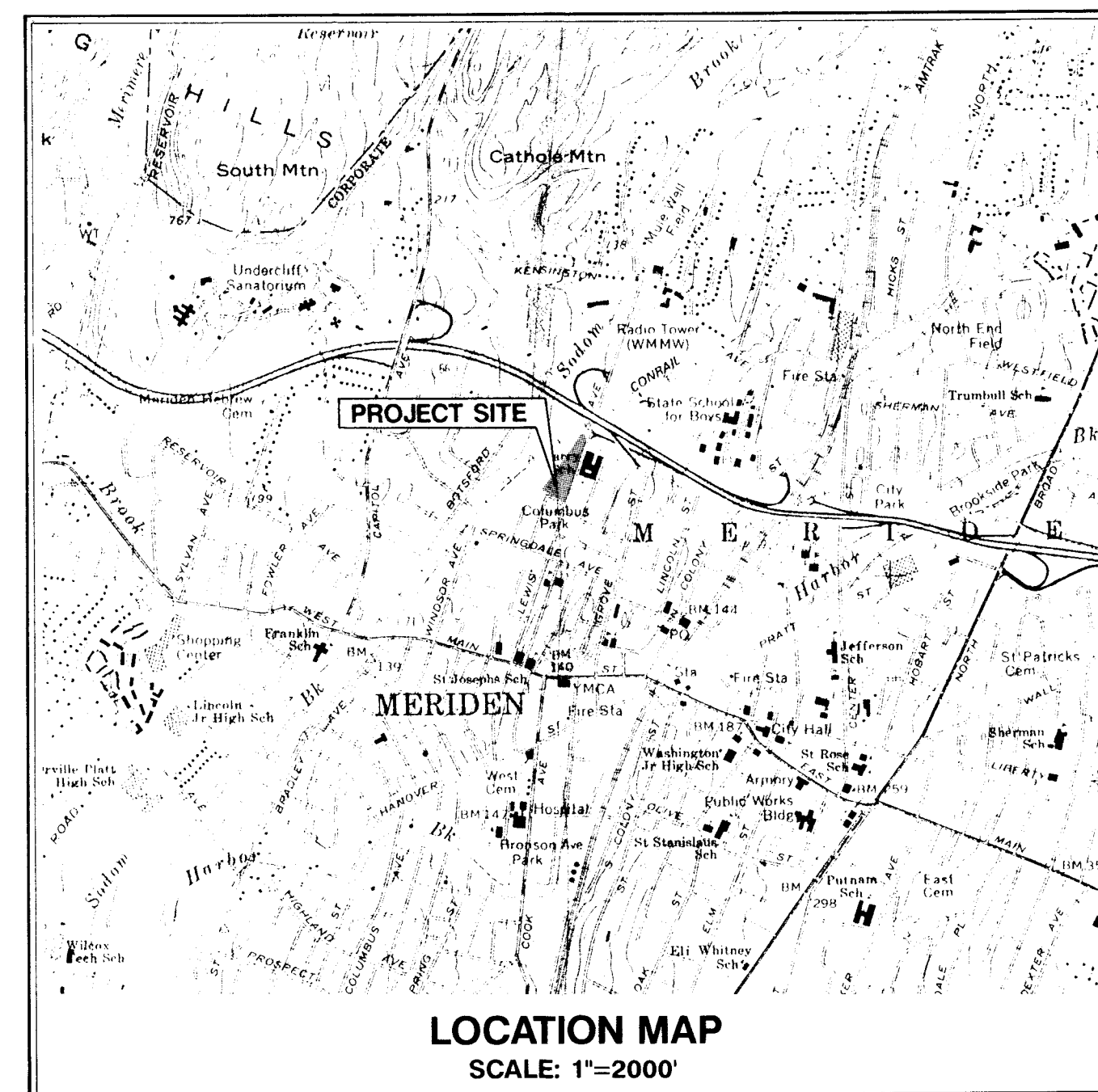

AUGUST 1992

MILONE & MACBROOM, INC.

Civil and Water Resource Engineering • Landscape Architecture • Planning
Cheshire, Connecticut

LIST OF DRAWINGS

- 1 SITE PLAN
- 2 WEST SIDE LEWIS AVENUE

9.000KM

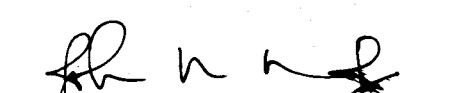
RECOMMENDED BY: 
JOHN M. MILONE, P.E.

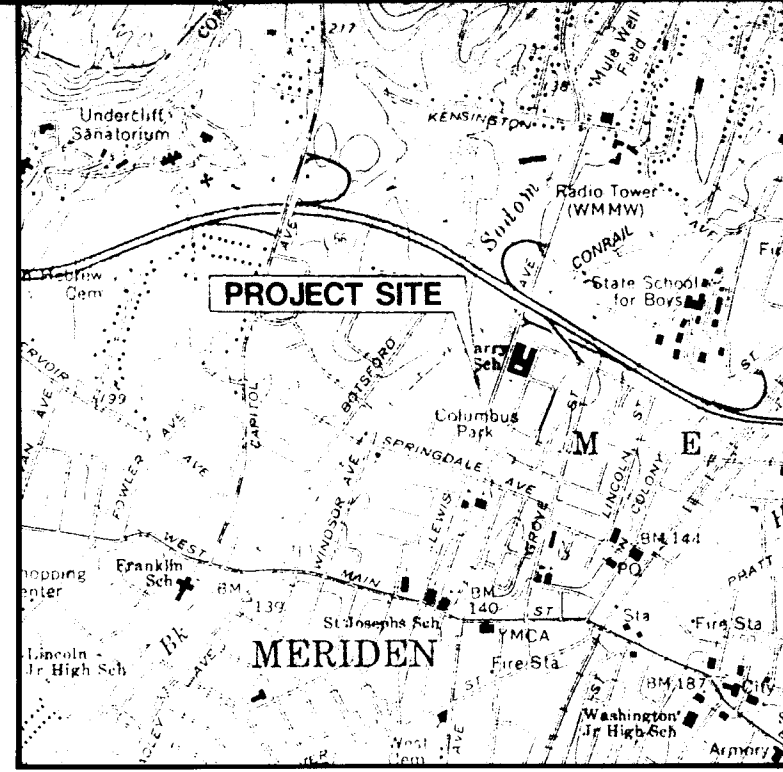

LOCATION MAP
SCALE: 1"=2000'

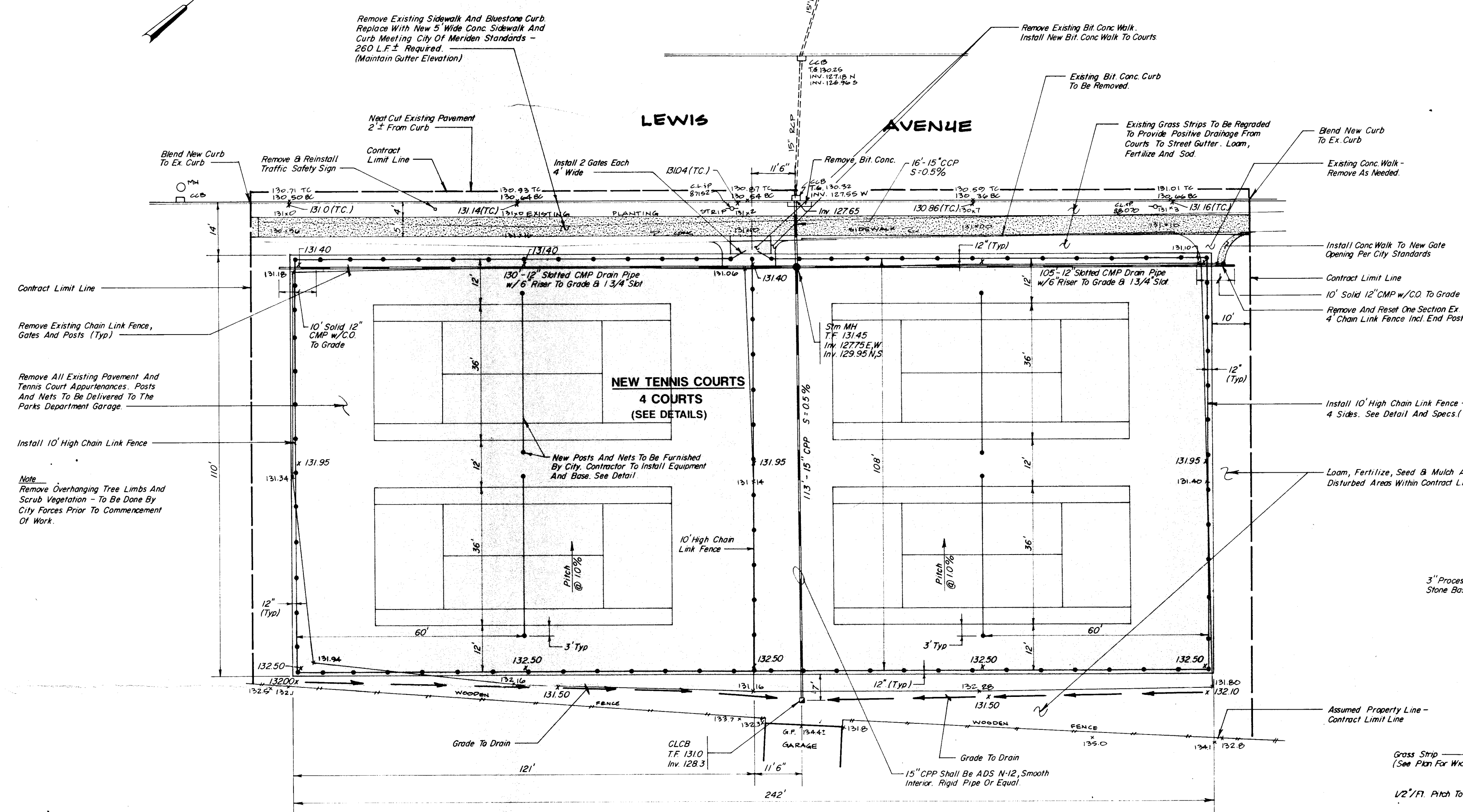

BENCHMARK
NAIL IN CL & P 88071
EL. 132.41

- GENERAL NOTES**
1. THE UTILITIES WHERE SHOWN SHOULD BE CONSIDERED APPROXIMATE AND MAY NOT REPRESENT ACTUAL CONDITIONS. CONTRACTOR SHOULD BE AWARE THAT OTHER UTILITIES MAY EXIST. IT IS THE RESPONSIBILITY OF THE CONTRACTOR TO HAVE ALL UTILITIES MARKED IN THE FIELD BY THE UTILITY OWNER PRIOR TO ANY EXCAVATION. CONTRACT "CALL BEFORE YOU DIG": 1-800-922-4455. THE ENGINEER ACCEPTS NO RESPONSIBILITY FOR THE ACCURACY AND COMPLETENESS OF THE UTILITIES SHOWN ON THIS DRAWING.
 2. THE CONTRACTOR SHALL VERIFY ALL DIMENSIONS AND ELEVATIONS IN THE FIELD. ANY DISCREPANCIES SHALL BE BROUGHT TO THE ATTENTION OF THE ENGINEER FOR A DETERMINATION.
 3. ALL DISTURBED EARTH AREAS SHALL RECEIVE MIN. 6" TOPSOIL, FERTILIZE AND GRASS SEED.
 4. THE CORNERS OF THE PROPOSED TENNIS COURTS ARE TO BE STAKED IN THE FIELD AND APPROVED BY THE ENGINEER AFTER REMOVALS AND PRIOR TO THE START OF NEW CONSTRUCTION.
 5. EXISTING PAVEMENT MAY BE PULVERIZED AND UTILIZED IN THE FORMATION OF SUBGRADE.
 6. EXISTING CONDITIONS TAKEN FROM SURVEY ENTITLED: "TOPOGRAPHIC SURVEY OF COLUMBUS PARK, LEWIS AVENUE, MERIDEN, CONNECTICUT" BY CONKLIN & SOROKA, INC. DATED: APRIL, 1991.

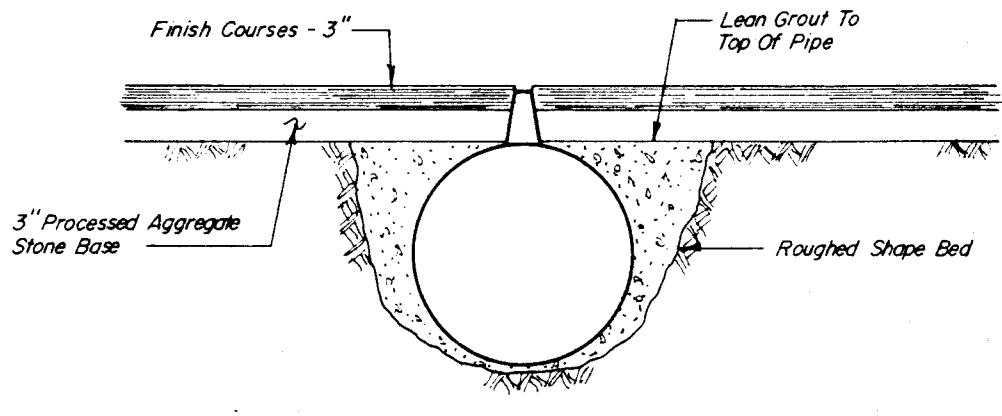

SLOTTED CMP DRAIN PIPE DETAIL

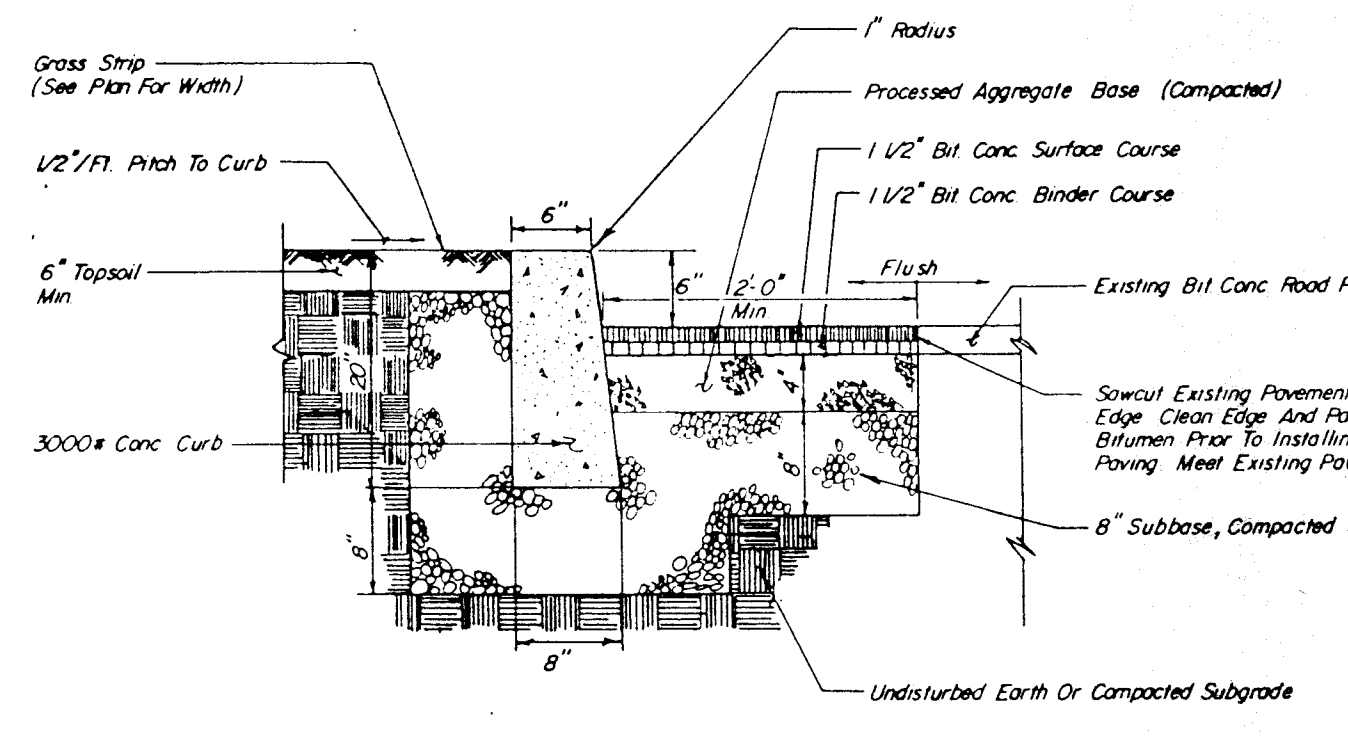

CONCRETE CURB

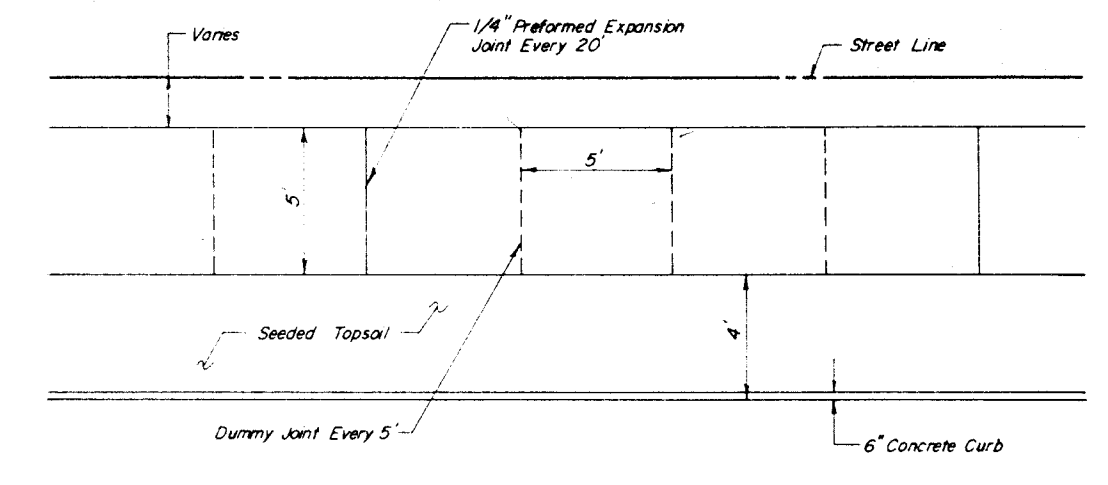

PLAN

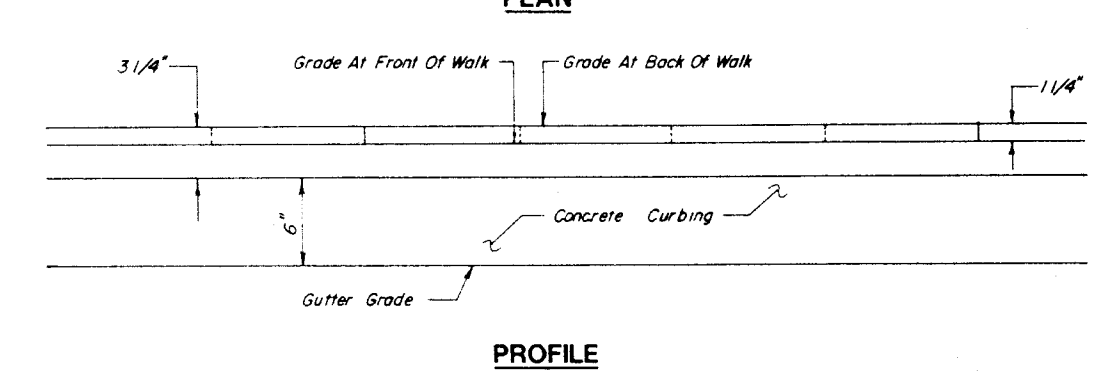

PROFILE

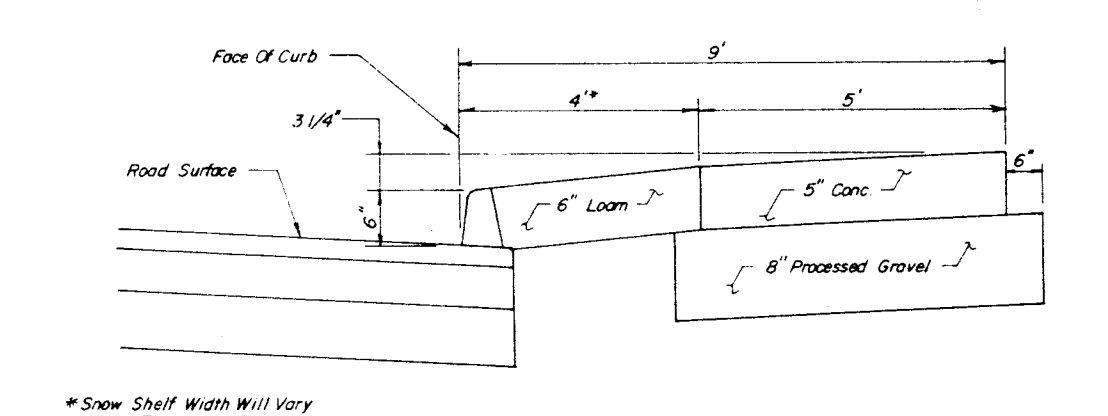

SECTION
TYPICAL SIDEWALK
NTS

SITE PLAN
TENNIS COURT RECONSTRUCTION
COLUMBUS PARK
LEWIS STREET
MERIDEN, CONNECTICUT

V.C.M. DESIGNED	W.J.N. DRAWN	J.M.M. CHECKED	MILONE & MACBROOM, INC.	261-53 PROJECT NO.
SCALE 1" = 20'			Civil and Water Resource Engineering • Landscape Architecture • Planning	1 OF 2
DATE AUGUST 1992			470 West Main Street • Cheshire, Connecticut 06410 (203) 271-1773 • FAX (203) 272-9733	SHEET NO.

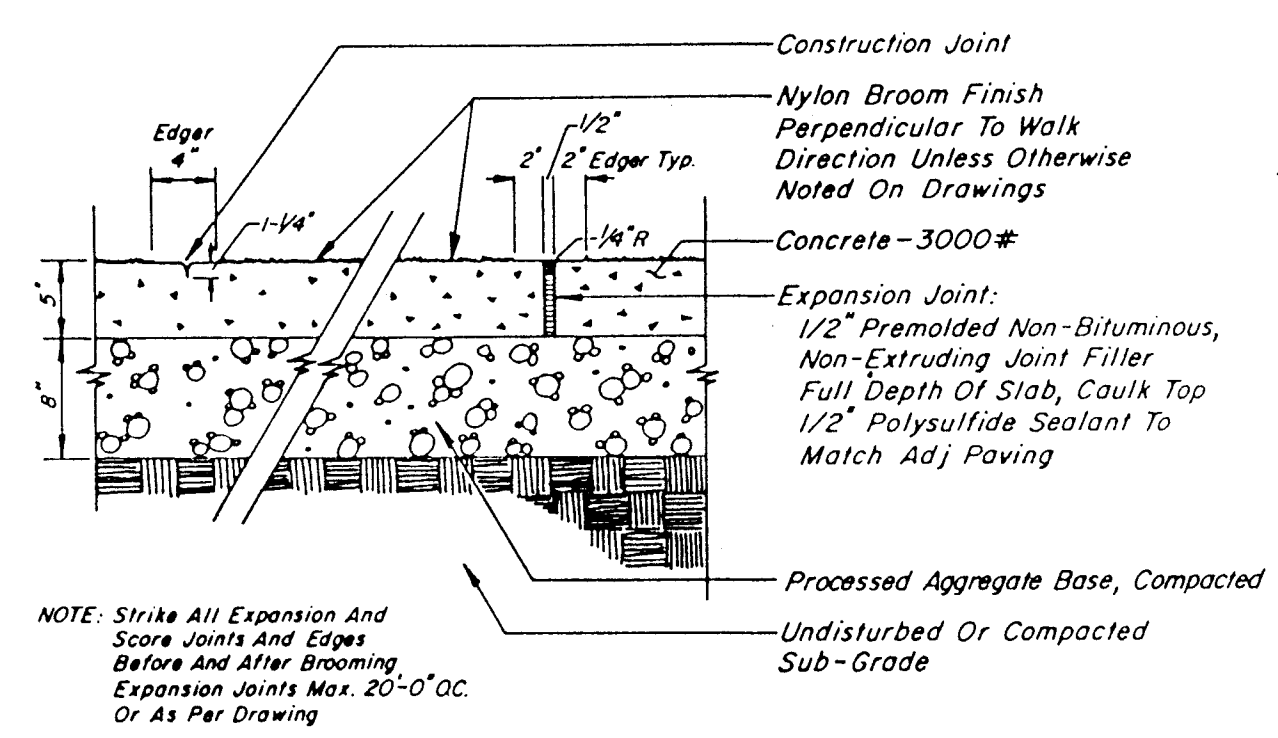

CONCRETE PAVING
SCALE 1" = 1'-0"

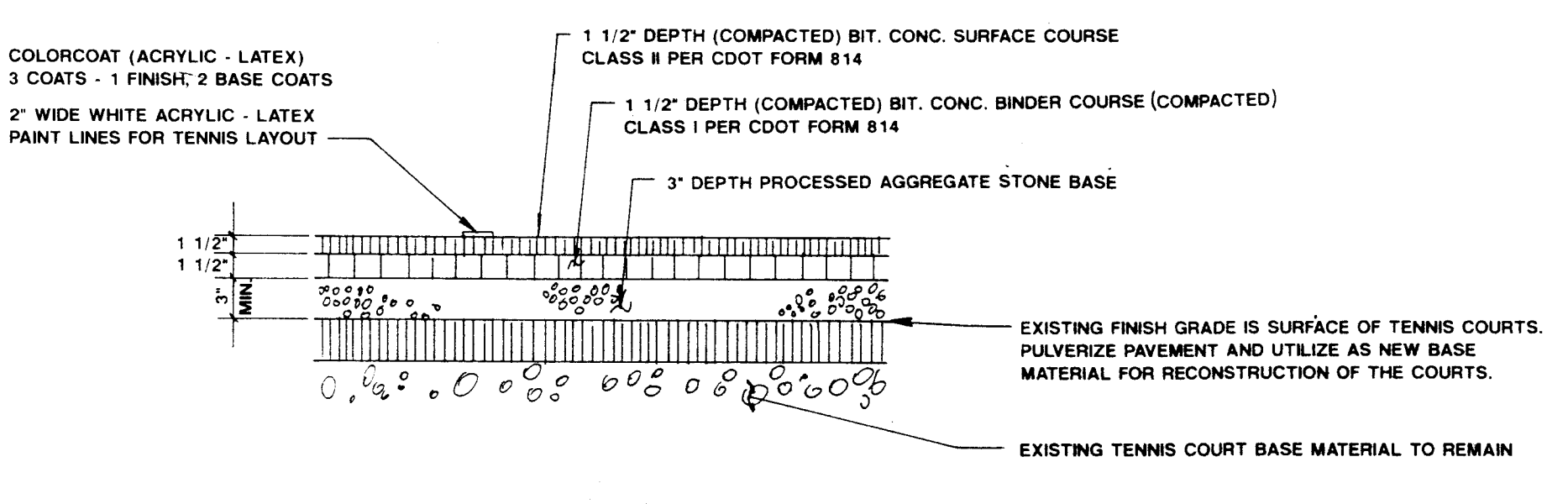

TYPICAL SECTION THROUGH COURTS
SCALE: 1" = 1'

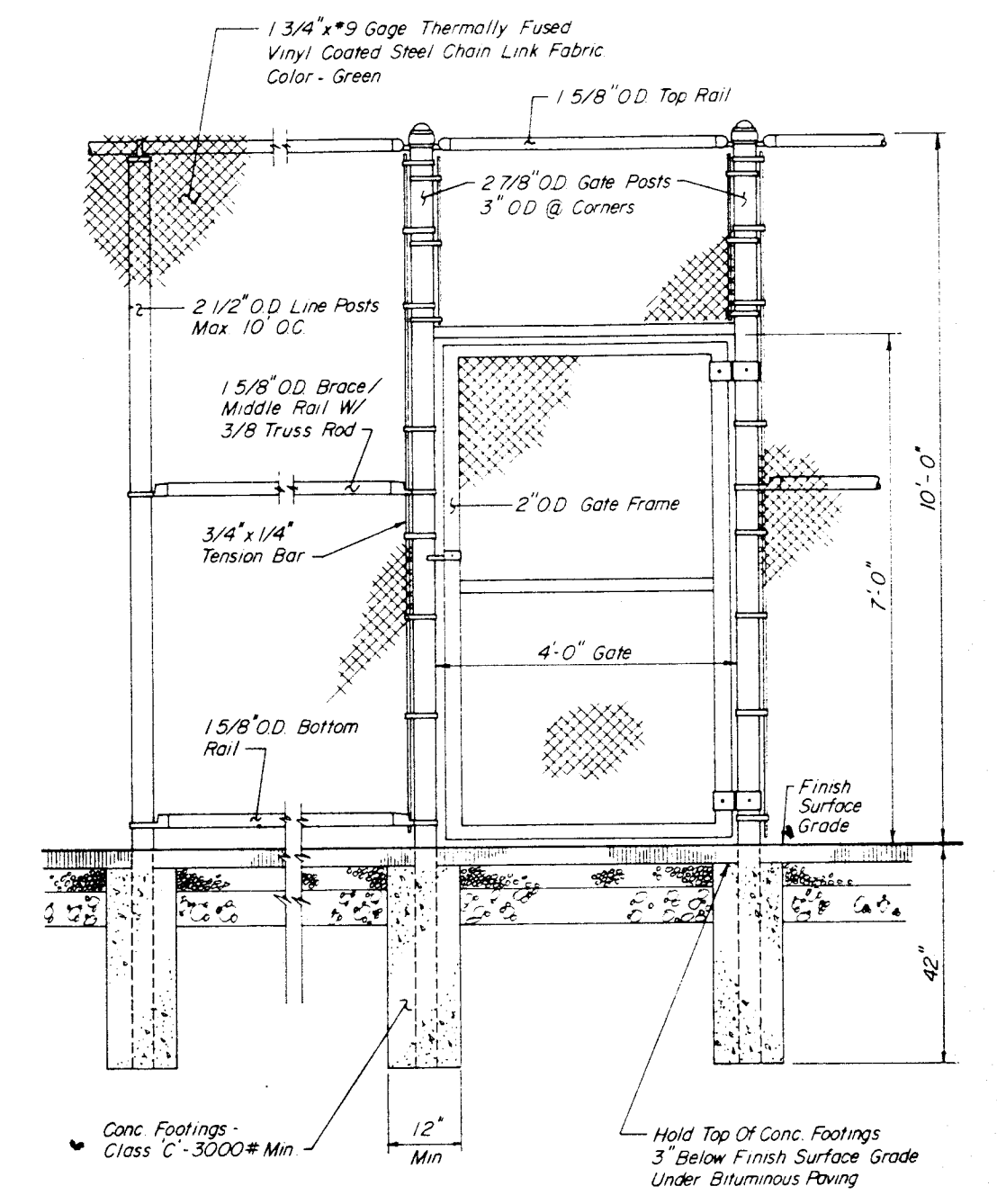

FENCE DETAIL

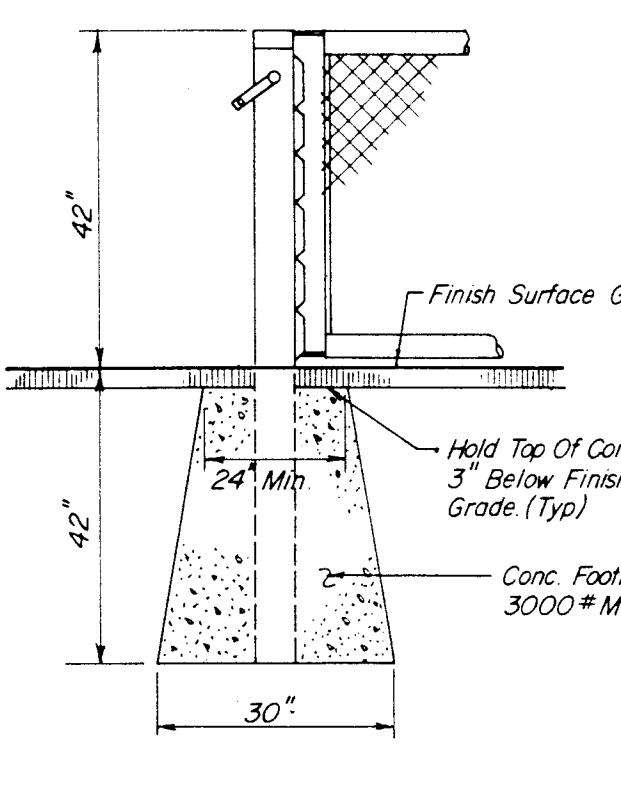

NET POST DETAIL

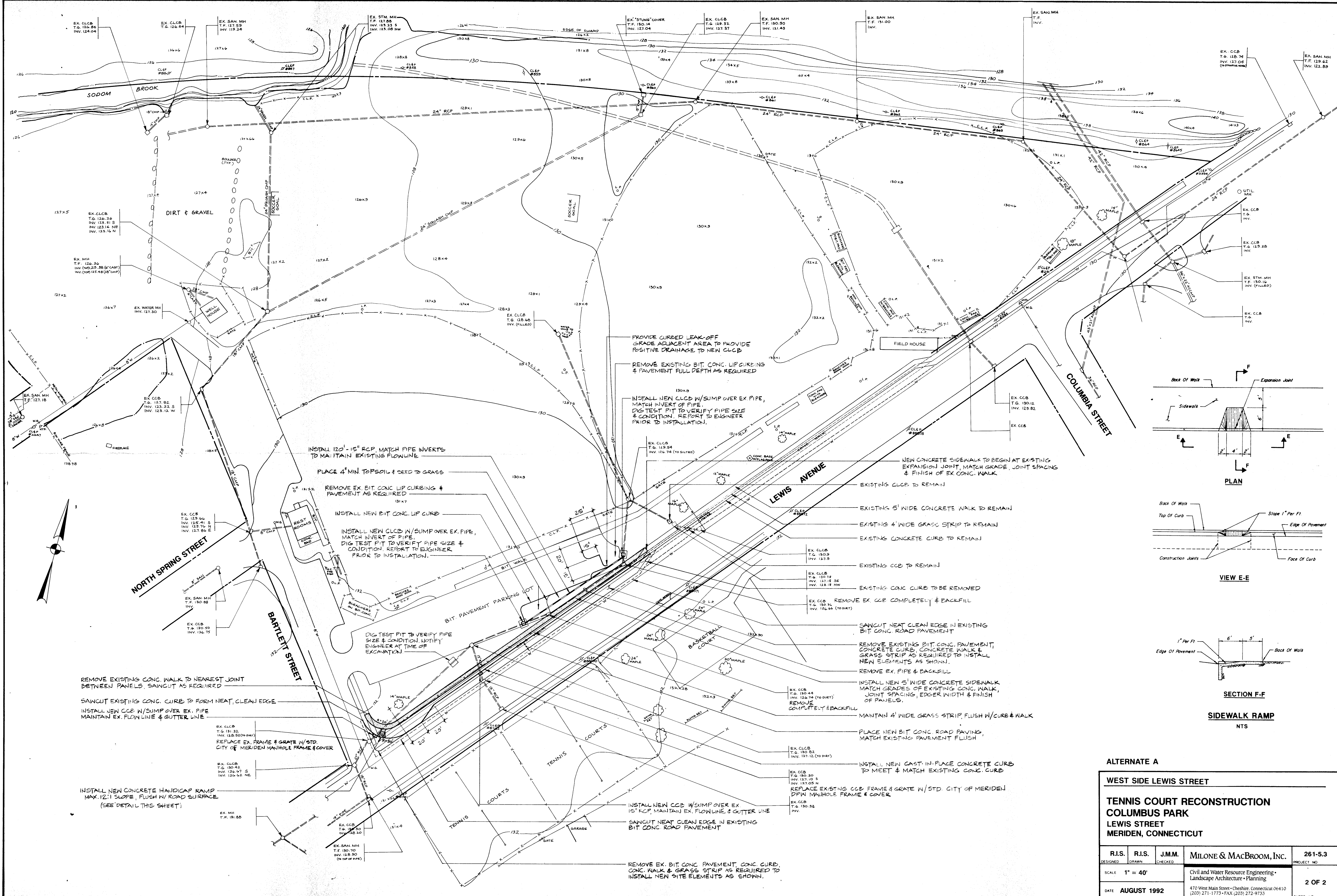

PROVIDE CURBED LEAK-OFF GRADE ADJACENT AREA TO PROVIDE POSITIVE DRAINAGE TO NEW CLCB

REMOVE EXISTING BIT CONC. LIP CURBING & PAVEMENT FULL DEPTH AS REQUIRED

INSTALL NEW CLCB W/ SUMP OVER EX PIPE, MATCH INVERT OF PIPE. DIG TEST PIT TO VERIFY PIPE SIZE & CONDITION. REPORT TO ENGINEER PRIOR TO INSTALLATION.

INSTALL 120" - 15" RCP. MATCH PIPE INVERTS TO MAINTAIN EXISTING FLOWLINE

PLACE 4" MIN TOPSOIL & SEED TO GRASS

REMOVE EX BIT CONC. LIP CURBING & PAVEMENT AS REQUIRED

INSTALL NEW BIT CONC. LIP CURB

INSTALL NEW CLCB W/ SUMP OVER EX PIPE, MATCH INVERT OF PIPE. DIG TEST PIT TO VERIFY PIPE SIZE & CONDITION. REPORT TO ENGINEER PRIOR TO INSTALLATION.

REMOVE EXISTING CONC. WALK TO NEAREST JOINT BETWEEN PANELS. SAWCUT AS REQUIRED

SAWCUT EXISTING CONC. CURB TO FORM NEAT, CLEAN EDGE

INSTALL NEW CCB W/ SUMP OVER EX. PIPE MAINTAIN EX. FLOWLINE & GUTTER LINE

REPLACE EX. FRAME & GRATE W/ STD. CITY OF MERIDEN MANHOLE FRAME & COVER

INSTALL NEW CONCRETE HANDICAP RAMP MAX. 12:1 SLOPE, FLUSH W/ ROAD SURFACE (SEE DETAIL THIS SHEET)

SAWCUT NEAT CLEAN EDGE IN EXISTING BIT CONC. ROAD PAVEMENT

REMOVE EXISTING BIT CONC. PAVEMENT, CONCRETE CURB, CONCRETE WALK & GRASS STRIP AS REQUIRED TO INSTALL NEW ELEMENTS AS SHOWN.

REMOVE EX. PIPE & BACKFILL

INSTALL NEW 5' WIDE CONCRETE SIDEWALK MATCH GRADES OF EXISTING CONC. WALK, JOINT SPACING, EDGER WIDTH & FINISH OF PANELS.

MAINTAIN 4' WIDE GRASS STRIP, FLUSH W/ CURB & WALK

PLACE NEW BIT CONC. ROAD PAVING, MATCH EXISTING PAVEMENT FLUSH

INSTALL NEW CAST-IN-PLACE CONCRETE CURB TO MEET & MATCH EXISTING CONC. CURB

REMOVE EX. BIT CONC. PAVEMENT, CONC. CURB, CONC. WALK & GRASS STRIP AS REQUIRED TO INSTALL NEW SITE ELEMENTS AS SHOWN.

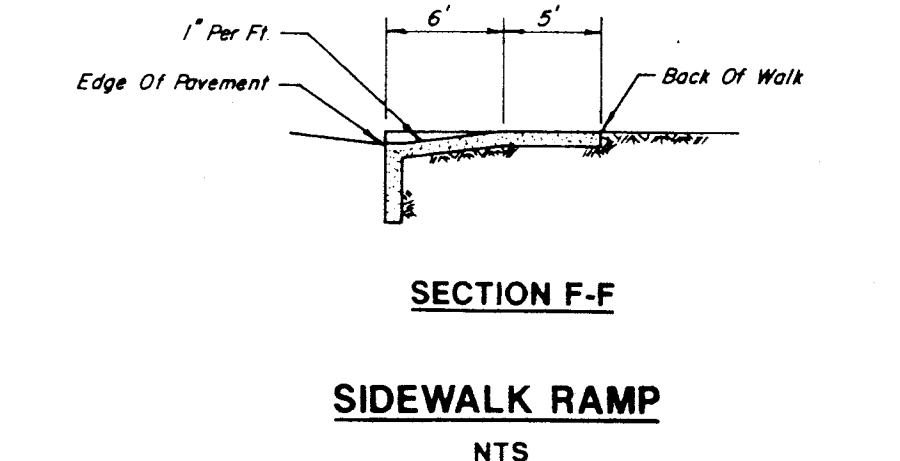
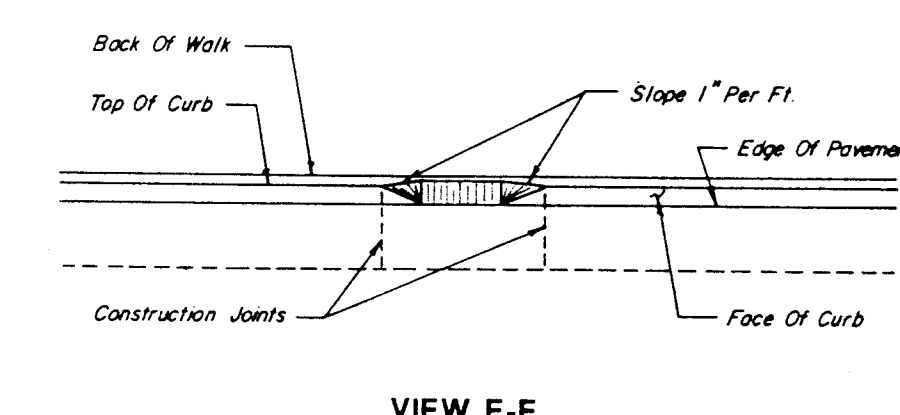
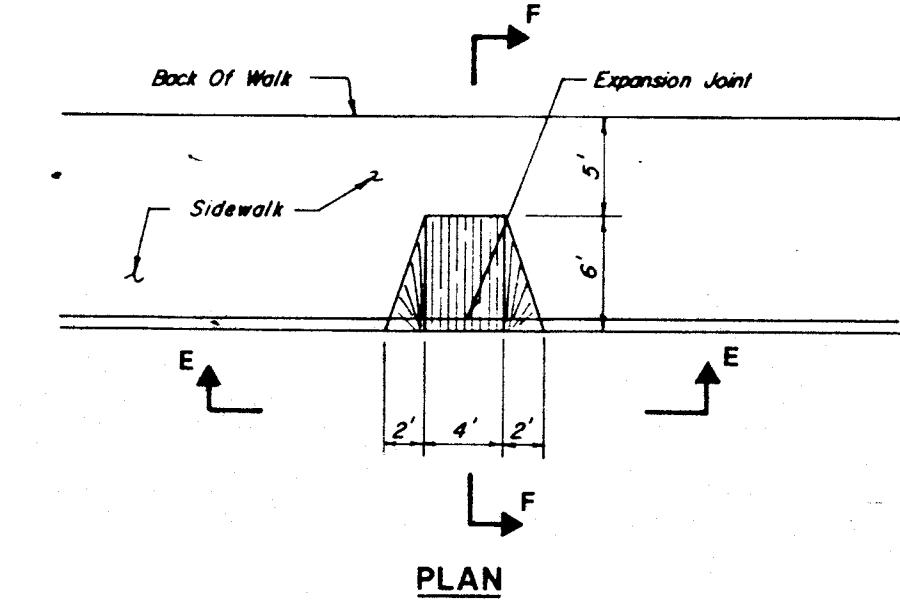

ALTERNATE A

WEST SIDE LEWIS STREET

TENNIS COURT RECONSTRUCTION
COLUMBUS PARK
LEWIS STREET
MERIDEN, CONNECTICUT

R.I.S. DESIGNED	R.I.S. DRAWN	J.M.M. CHECKED	MILONE & MacBROOM, INC.	261-53 PROJECT NO.
SCALE 1" = 40'			Civil and Water Resource Engineering • Landscape Architecture • Planning	2 OF 2
DATE AUGUST 1992			470 West Main Street • Cheshire, Connecticut 06410 (203) 271-1773 • FAX (203) 272-9733	SHEET NO.