

TREE PLANTING DETAIL

NOT TO SCALE

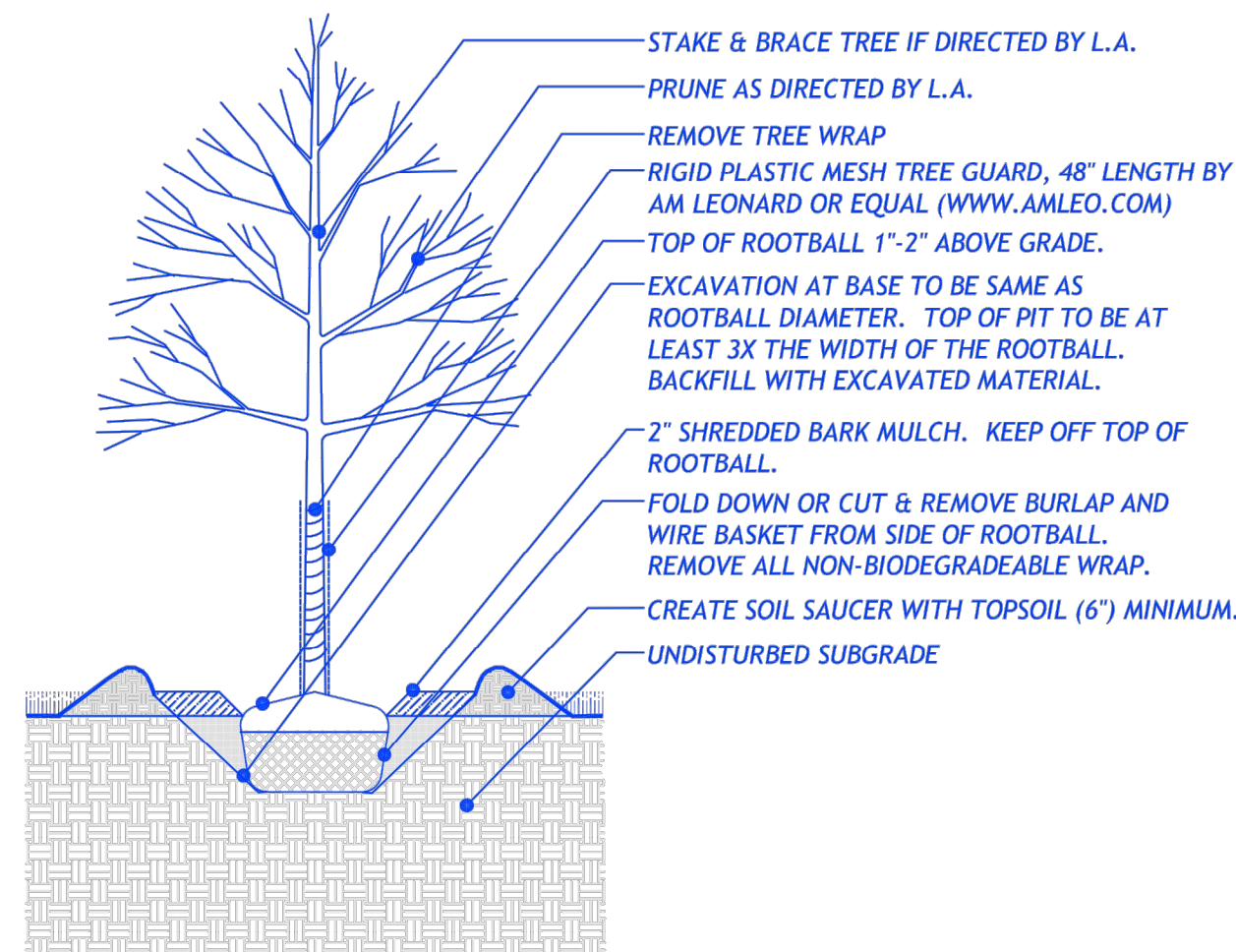

CONSTRUCTION NOTES

- WORK DESCRIPTION**
PROVIDE ALL MEANS AND MATERIALS NECESSARY FOR SUPPLYING, INSTALLING, AND MAINTAINING THE TYPE AND SIZE OF THE PLANT MATERIAL AND OTHER IMPROVEMENTS INDICATED IN THE SITE PLAN FOR A PERIOD OF ONE YEAR.
- QUALITY ASSURANCE**
WETLAND SCIENTIST SHALL BE ON-SITE TO MONITOR CONSTRUCTION, MONITORING AND MAINTENANCE OF THE HABITAT ENHANCEMENT ACTIVITIES TO ENSURE COMPLIANCE WITH THE DESIGN AND SPECIFICATIONS AND TO MAKE ADJUSTMENTS WHEN APPROPRIATE TO MEET ENHANCEMENT OBJECTIVES.
ALL WORK SHALL BE PERFORMED BY PERSONNEL WITH WETLAND AND STREAM BANK HABITAT RESTORATION AND ENHANCEMENT PROJECT EXPERIENCE, UNDER THE DIRECTION OF A SKILLED FOREMAN WITH A MINIMUM THREE YEARS EXPERIENCE.
THE PLANNING, RECONSTRUCTION AND MAINTENANCE OF THE HABITAT ENHANCEMENT ACTIVITIES ARE THE RESPONSIBILITY OF THE CITY OF MERIDEN.
ALL HEAVY EQUIPMENT STORAGE, REFUELING AND MINOR MAINTENANCE IS TO TAKE PLACE OUTSIDE OF THE REGULATED WETLANDS AND WATERCOURSES.
DISPOSE OF EXCESS MATERIAL AND DEBRIS RESULTING FROM THE PROPOSED HABITAT ENHANCEMENT WORK OFF-SITE. LEAVE WORK AREA CLEAN AND NEAT UPON COMPLETION OF THE WORK. REPAIR ANY DAMAGED DONE TO THE EXISTING SITE IMPROVEMENT AS A RESULT OF THE WORK.
- PRODUCT AND EXECUTION DATA**
 - SOIL**
 - TOPSOIL SHALL CONSIST OF A MIXTURE OF EQUAL VOLUMES OF ORGANIC AND MINERAL MATERIALS. WELL DECOMPOSED LEAF-COMPOST OR EQUAL (NOT INCLUDING PEAT) SHALL BE USED FOR THE ORGANIC MATERIAL, WHICH SHALL BE FREE OF WEED SEEDS AND PHYSICAL (E.G., PLASTIC) AND CHEMICAL CONTAMINANTS. THE ORGANIC MATTER CONTENT SHOULD BE 15 TO 25 PERCENT BY DRY WEIGHT.
 - PROVIDE DOCUMENTATION REGARDING THE SOURCE OF TOPSOIL AND THE POTENTIAL FOR THE PRESENCE OF INVASIVE SPECIES SEEDS.
 - TESTING OF THE TOPSOIL BY AN ACCEPTABLE LABORATORY PRIOR TO PLANTING WILL BE THE RESPONSIBILITY OF THE SITE CONTRACTOR.
 - SPREAD TOPSOIL TO DEPTH REQUIRED TO ACHIEVE THE MICROTOPOGRAPHIC VARIATION AND TO MEET THICKNESS, GRADES, AND ELEVATIONS SHOWN ON THE PLAN AND DETAILS.
 - VEGETATION**
 - GENERAL**
 - NON NATIVE, NON INVASIVE ANNUALS MAY BE USED FOR TEMPORARY PLANTINGS IF APPROVED BY THE OWNER'S REPRESENTATIVE.
 - PROVIDE A CERTIFICATE OR INVOICE FROM THE PLANT MATERIAL SUPPLIERS INDICATING THE PLANT SOURCE, THE BOTANICAL NAME, QUANTITY, AND SIZE OF THE PLANTS DELIVERED TO THE PROJECT SITE, IN ADDITION TO PROVIDING ALL PLANT LABELS.
 - ALL PLANT MATERIALS SHALL BE INSPECTED FOR DEFECTS, DISEASE, DAMAGE OR INSECTS BEFORE PLANTING. ANY SUBSTANDARD PLANTS SHALL BE RETURNED TO, AND REPLACED BY THE CONTRACTOR. ACCEPTABLE PLANTINGS ARE TO BE PLANTED PER THE SPECIFICATIONS OF THE PLANTING PLAN.
 - ALL PLANT MATERIALS ARE SUBJECT TO REPLACEMENT BY SUITABLE ALTERNATIVES PER AGREEMENT BETWEEN THE PROPERTY OWNER, NURSERY CONTRACTOR, AND APPROPRIATE REGULATORY AGENCIES (E.G., CORPS).
 - ALL PLANT MATERIAL LOCATIONS ARE SUBJECT TO FIELD ADJUSTMENTS IN RESPONSE TO SITE CONDITIONS. THESE ADJUSTMENTS SHALL BE THE DISCRETION OF THE PROPERTY OWNER. UNDER THE DIRECTION OF A QUALIFIED WETLAND SCIENTIST, UP TO 50 PERCENT OF THE PLANTS MAY BE LOCATED DIFFERENTLY THAN SHOWN ON THE DRAWINGS.
 - SIZES SHALL CONFORM TO MEASUREMENTS SPECIFIED IN THE PLANT LIST. USE PLANTS LARGER THAN SPECIFIED IF APPROVED BY THE OWNER'S REPRESENTATIVE, AND CAUSES NO INCREASE TO THE CONTRACT PRICE.
 - MAKE ALL NECESSARY MEASUREMENTS TO PROPERLY LOCATE PLANTS AS SHOWN ON THE DRAWING. LOCATIONS OF PLANTS SHALL BE VERIFIED BY PROPERTY OWNER PRIOR TO INSTALLATION. ANY PLANTS INSTALLED PRIOR TO THE APPROVAL OF THE PROPERTY OWNER SHALL BE RELOCATED AT NO ADDITIONAL COST TO THE OWNER. PRIOR TO PLANTING, VERIFY LOCATIONS OF ALL UNDERGROUND UTILITIES. EXERCISE CARE WHEN DIGGING IN THESE AREAS. ASSUME RESPONSIBILITY FOR ANY DAMAGE AND REPLACEMENT OR REPAIR AT THE CONTRACTOR'S EXPENSE.
 - TREES AND SHRUBS**
 - PLACE THE PLANT IN THE CENTER OF THE PIT OR SPACED IN BEDS AS INDICATED ON THE DRAWINGS. SET THE PLANT PLUMB AND ADJUST ITS HEIGHT TO ACHIEVE THE ELEVATION SHOWN ON THE DRAWINGS BY PLACING PREPARED SOIL BENEATH THE ROOTBALL. BURLAP, ROPE, WIRE BASKETS OR OTHER MATERIAL SHALL BE CUT AND REMOVED FROM THE TOPS OF THE ROOTBALL AND NOT LEFT IN THE PLANTING PIT. BACKFILL AROUND THE ROOTBALL WITH PREPARED PLANTING SOIL. UNIFORMLY COMPACT AND WATER THE PREPARED PLANTING SOIL TO FILL VOIDS AND TO FIRMLY SECURE ROOTBALL.
 - FORM A "SAUCER" AT THE SURFACE OF THE PLANTING PIT OR BED WITH TOPSOIL. SHAPE THE SAUCER TO THE DIMENSIONS INDICATED ON THE DRAWINGS. BLEND THE PERIMETER OF THE SAUCERS AND BEDS TO FORM A SMOOTH AND UNIFORM TRANSITION TO FINISH GRADE.
 - IMMEDIATELY AFTER PLANTING, FIRMLY INSTALL STAKES AS INDICATED ON THE DRAWINGS. ATTACH GUY WIRES, TURNBUCKLES AND FRICTION GUARDS TO TREE AND STAKES. TIE WIRES TO SECURELY ANCHOR TREE.
 - COVER ALL TREE PITS AND PLANTING BEDS WITH THE SPECIFIED GUARD DEPTH, DIMENSIONS, AND AREAS INDICATED ON THE DRAWING.
 - PRUNE IN ACCORDANCE WITH AMERICAN ASSOCIATION OF NURSERYMEN STANDARDS TO REMOVE DEAD AND DISEASED PORTION OF THE PLANT.
 - ALL WIRE FLAGS USED TO IDENTIFY PLANT LOCATIONS SHALL BE REMOVED AFTER PLANT INTRODUCTION AND CONFIRMATION BY THE PROPERTY OWNER.
 - HERBS - SEEDING**
 - USE PURE LIVE SEED ONLY.
 - SEED WHEN SOILS ARE NOT INUNDATED. DO NOT ALLOW INUNDATION TO OCCUR UNTIL THE HEIGHT OF SEEDED PLANTS EXCEED INUNDATION DEPTHS.
 - SURFACE-SOW SEED AND THEN PUSH SEED INTO CONTACT WITH THE TOPSOIL.
 - APPLY SEED AT RATES AS SPECIFIED ON THE PLANT LIST.
 - SURFACE PREPARATION. LOOSEN SUBGRADE OF THE PLANTING BED AREAS TO A MINIMUM DEPTH OF 1".
 - IMMEDIATELY FOLLOWING SEEDING, MULCH THE SEEDED SURFACE WITH STERILE STRAW AT A RATE OF 1.5 TO 3 TONS/ACRE. SPREAD MULCH BY HAND OR DISK HARROW SET STRAIGHT.
 - LIMIT OF SEEDING IS SUBJECT TO FIELD ADJUSTMENT IN RESPONSE TO SITE CONDITIONS. THESE ADJUSTMENTS SHALL BE AT THE DISCRETION OF THE PROJECT WETLAND SCIENTIST.
 - TEMPORARY EROSION AND SEDIMENT CONTROL MEASURES: UNLESS NOTED OTHERWISE, THE MEASURES SHALL BE INSTALLED AND MAINTAINED IN ACCORDANCE WITH THE 2002 CONNECTICUT GUIDELINES FOR SOIL EROSION AND SEDIMENT CONTROL (2002 GUIDELINES).**
 - COIR LOGS SHALL BE INSTALLED PER THE MANUFACTURER'S RECOMMENDATIONS AND SHALL BE E2-LOG AS SOLD BY ECODEPOT (WWW.ECODEPOTS.COM) OR APPROVED EQUAL.
 - EROSION CONTROL BLANKETS SHALL BE INSTALLED IN ACCORDANCE WITH THE MANUFACTURER'S RECOMMENDATIONS AND SHALL BE ECS-2B AS SOLD BY EAST COAST EROSION CONTROL (WWW.EASTCOASTEROSION.COM) OR APPROVED EQUAL.

MAINTENANCE

- MAINTENANCE IS TO BEGIN IMMEDIATELY AFTER PLANTING HAS BEEN COMPLETED.
 - THE MAINTENANCE PERIOD SHALL BE EXTENDED AT NO ADDITIONAL COST TO THE PROPERTY OWNER UNTIL PREVIOUS PUNCH LIST ITEMS HAVE BEEN CORRECTED, AT WHICH TIME THE FINAL INSPECTION WILL BE MADE.
 - ALL PLANT MATERIAL SHALL BE PRUNED, WEEDED, AND SOIL AMENDMENTS ADDED AS REQUIRED TO KEEP PLANT MATERIAL IN A HEALTHY GROWING CONDITION.
 - PROTECT ALL PLANTED AREAS AGAINST DAMAGE, INCLUDING EROSION, WILDLIFE, AND TRESPASSING BY PROVIDING AND MAINTAINING PROPER SAFEGUARDS.
 - ALL PLANT STOCK SHALL BE WATERED UPON COMPLETION OF PLANTINGS. ARRANGEMENTS SHALL BE MADE TO PROVIDE ADEQUATE IRRIGATION TO INTRODUCE PLANTING STOCK AND SEEDED AREAS UNTIL PLANTS ARE FIRMLY ESTABLISHED. IRRIGATION SHALL NOT BE USED TO PROVIDE WETLAND HYDROLOGY. IRRIGATION SHALL BE DISCONTINUED AND MEASURES SHALL BE REMOVED NO LATER THAN THE END OF THE SECOND GROWING SEASON UNLESS SPECIFIED OTHERWISE.
 - RESET SETTLED PLANTS TO PROPER GRADE AND POSITION. ADJUST OR REPLACE STAKES, GUYING MATERIALS, TO SECURELY ANCHOR AND PROTECT.
 - AT THE END OF THE MAINTENANCE PERIOD, ALL PLANT MATERIAL SHALL BE IN A HEALTHY GROWING CONDITION AS RELATED TO CONDITIONS WITHIN THE CONTROL OF THE CONTRACTOR.
 - CONTROL INVASIVE SPECIES FOR A MINIMUM OF THREE YEARS FOLLOWING THE CONSTRUCTION PHASE OF THE PROJECT.
 - INVASIVE SPECIES ARE THOSE SPECIES IDENTIFIED IN SECTION 4F. OF THE "NEW ENGLAND DISTRICT COMPENSATORY MITIGATION GUIDANCE" DATED JULY 10, 2010 AND PUBLISHED BY THE US ARMY CORP OF ENGINEERS.
 - CONDUCT THE CONTROL ACTIVITIES UNDER THE DIRECTION OF A QUALIFIED WETLAND SCIENTIST AT LEAST TWICE EACH GROWING SEASON - IN LATE SPRING/EARLY SUMMER AND AGAIN IN LATE SUMMER/EARLY FALL. MONITORING AND MAINTENANCE WILL INCLUDE:
 - DETERMINE THE PRESENCE AND ABUNDANCE OF INVASIVE PLANTS.
 - FIELD MARK (BY FLAGGING OR OTHER MEANS) DESIRABLE VEGETATION TO REMAIN AND INVASIVE (UNDESIRABLE) PLANTS TO BE CONTROLLED.
 - CONTROL INVASIVE PLANTS VIA PHYSICAL OR CHEMICAL METHODS. THE METHOD TYPE WILL BE DETERMINED BY THE WETLAND SCIENTIST BASED ON THE TYPE AND ABUNDANCE OF INVASIVE PLANTS AND THE TYPE AND ABUNDANCE OF ADJACENT DESIRABLE PLANTS. THE PLANT CONSERVATION ALLIANCE'S ALIEN PLANT WORKING GROUP DATABASE (HTTP://WWW.NPS.GOV/PLANTS/ALIEN/FACTMAIN.HTM) REGARDING THE CONTROL OF INVASIVE PLANT SPECIES WILL BE CONSULTED TO ASSIST WITH SPECIFYING AN APPROPRIATE METHODOLOGY. COMPLETE PHYSICAL PLANT CONTROL ACTIVITIES BY HAND OR VIA HAND TOOLS (E.G., WEED WRENCH, BRUSH CUTTER). CHEMICAL METHODS WILL PRIMARILY INCLUDE THE USE OF GLYPHOSATE-BASED HERBICIDES IN ACCORDANCE WITH MANUFACTURER'S RECOMMENDATIONS AND APPLICABLE LAWS.
- MONITORING AND REPORTING:**
 - MONITOR THE CONDITIONS OF THE HABITAT ENHANCEMENT IMPROVEMENTS FOR THREE YEARS. THE FIRST YEAR OF MONITORING SHALL BEGIN FOLLOWING THE FIRST FULL GROWING SEASON FOLLOWING CONSTRUCTION COMPLETION AND PLANTING.
 - CONDUCT MONITORING ACTIVITIES AT LEAST TWICE EACH GROWING SEASON - IN LATE SPRING/EARLY SUMMER AND AGAIN IN LATE SUMMER/EARLY FALL.
 - THE PROJECT WETLAND SCIENTIST SHALL PREPARE AND SUBMIT AN ANNUAL MONITORING REPORT TO THE REGULATORY AGENCIES BY DECEMBER 15TH OF EACH MONITORING YEAR. A SELF-CERTIFICATION FORM WILL BE COMPLETED AND SIGNED AS A TRANSMITTAL COVER SHEET FOR EACH ANNUAL MONITORING REPORT.
 - THE MONITORING REPORTS SHALL BE CONCISE (MAXIMUM 10 PAGES) AND EFFECTIVELY PROVIDE THE INFORMATION NECESSARY TO ASSESS THE STATUS OF THE COMPENSATORY MITIGATION PROJECT. THE REPORTS SHALL INCLUDE:
 - PROJECT OVERVIEW
 - CONCLUSIONS REGARDING WHETHER THE HABITAT ENHANCEMENT PLAN IS SUCCESSFULLY ACHIEVING THE ENHANCEMENT OBJECTIVES. IN ADDITION, INFORMATION REGARDING THE DISCOVERY OF POTENTIAL INVASIVE PLANTS AND CONTROL ACTIONS TAKEN SHALL BE PROVIDED.
 - SUMMARY DATA AND PHOTOS TO SUBSTANTIATE THE NOTED CONCLUSIONS.
 - MAPS SHOWING LOCATION OF HABITAT ENHANCEMENT AREA AND SURROUNDING HABITATS, LOCATION OF PHOTOGRAPHIC REFERENCE POINTS, TRANSECTS, SAMPLING DATA POINTS AND/OR OTHER FEATURES PERTINENT TO THE ENHANCEMENT PLAN.
 - THE MAPS SHOULD INCLUDE A LEGEND AND SHOULD FIT ON AN 8.5 X 11 INCH SHEET.
 - CONCLUSIONS. IF APPLICABLE, A BRIEF DISCUSSION OF THE DIFFICULTIES, POTENTIAL REMEDIAL ACTIONS, AND TIME-TABLE PROPOSED BY THE PERMITTEE.
 - AS-BUILT PLAN WITH 1-FOOT CONTOURS, STRUCTURES, EXTENT OF PLANT COMMUNITIES (FIRST YEAR ONLY).
 - WITHIN 60 DAYS OF COMPLETING THE CONSTRUCTION PHASE OF THE HABITAT ENHANCEMENT PLAN, SUBMIT SIGNED LETTER TO THE REGULATORY AGENCIES SPECIFYING THE DATE OF COMPLETION. IF HABITAT ENHANCEMENT CONSTRUCTION ACTIVITIES ARE NOT COMPLETED BY DECEMBER 31 OF ANY GIVEN YEAR, THE PERMITTEE SHALL PROVIDE THE REGULATORY AGENCIES WITH A LETTER PROVIDING THE DATE MITIGATION WORK BEGAN AND THE WORK COMPLETED AS OF DECEMBER 31. THE LETTER WILL BE SENT NO LATER THAN JANUARY 31 OF THE NEXT YEAR.
 - DURING THE FINAL YEAR OF MONITORING, AN ADDITIONAL ASSESSMENT AND REPORT SHALL BE COMPLETED BY A WETLAND SCIENTIST OTHER THAN THE WETLAND SCIENTIST THAT COMPLETED THE ANNUAL MONITORING REPORTS. THE ASSESSMENT REPORT SHALL:
 - SUMMARIZE THE ORIGINAL AND MODIFIED HABITAT ENHANCEMENT OBJECTIVES AND DISCUSS THE LEVEL OF ATTAINMENT OF THESE OBJECTIVES.
 - DESCRIBE SIGNIFICANT PROBLEMS AND SOLUTIONS DURING CONSTRUCTION AND MAINTENANCE (MONITORING) OF THE HABITAT ENHANCEMENT AREA.
 - IDENTIFY REGULATORY AGENCY PROCEDURES OR POLICIES THAT ENCUMBERED IMPLEMENTATION OF THE HABITAT ENHANCEMENT PLAN.
 - RECOMMEND MEASURES TO IMPROVE THE EFFICIENCY, REDUCE THE COST, OR IMPROVE THE EFFECTIVES OF SIMILAR PROJECTS IN THE FUTURE.

TEMPORARY EROSION CONTROL BLANKETS

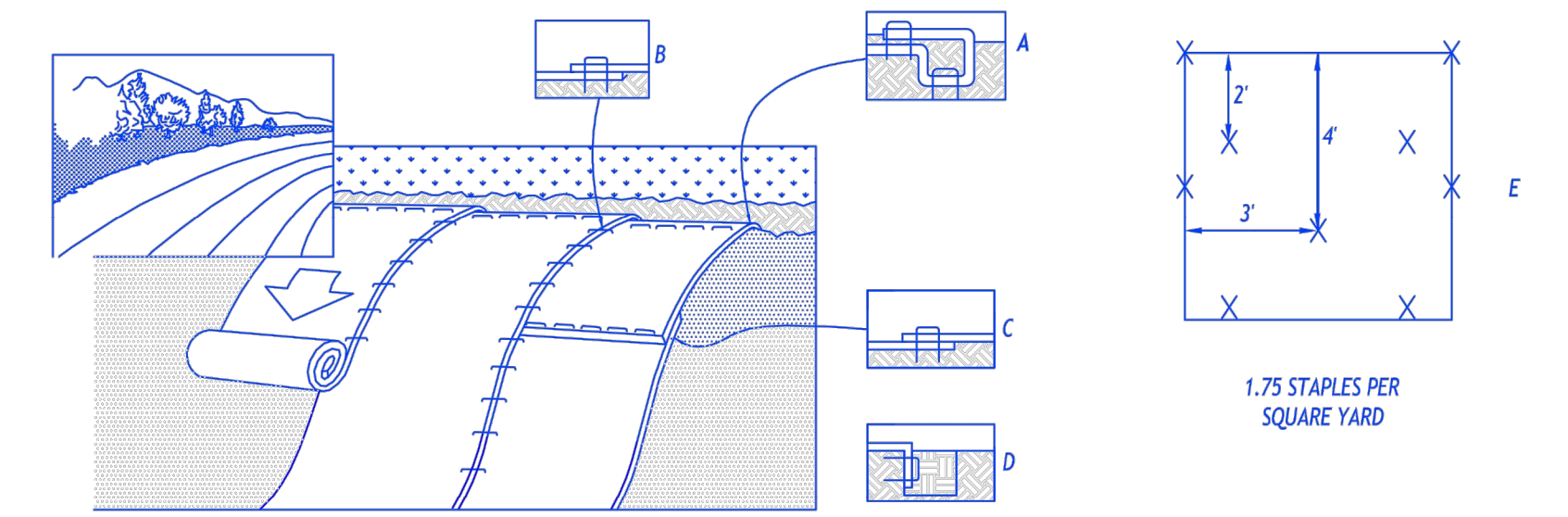

- DIG A 6" BY 6" TRENCH BOTH UP-SLOPE AND DOWN-SLOPE OF THE AREA THE MATTING IS TO BE APPLIED. PREPARE THE SOIL SURFACE (RAKING, SEEDING AND FERTILIZING).
- BEGIN BY PLACING THE BLANKET A MINIMUM OF 12" UP-SLOPE OF THE UP-SLOPE TRENCH. SECURE THE BLANKET AT THE BOTTOM OF THE TRENCH WITH STAPLES PLACED 12" APART. BACKFILL AND COMPACT THE TRENCH. APPLY SEED, AND FOLD THE BLANKET OVER SOIL. SECURE WITH A ROW OF STAPLES PLACED 12" APART ACROSS THE WIDTH OF THE BLANKET. (DIAGRAM A)
- ROLL THE BLANKET VERTICALLY DOWN THE SLOPE. INSTALL STAPLES IN PATTERN SHOWN ON DIAGRAM E.
- PARALLEL BLANKETS MUST BE OVERLAPPED BY A MINIMUM OF 4", AND SECURED WITH A ROW OF STAPLES PLACED APPROXIMATELY 3'-0" APART. (DIAGRAM B)
- ADDITIONAL VERTICAL BLANKETS CAN BE JOINED USING A MINIMUM 4" OVERLAPPING OR SHINGLE STYLE (DIAGRAM C) IN THE DIRECTION OF WATER FLOW. CONNECT THE BLANKETS BY PLACING STAPLES APPROXIMATELY 12" APART ACROSS THE WIDTH OF THE BLANKETS.
- PLACE A ROW OF STAPLES 4" APART ALONG THE OUTER END OF THE LAST BLANKET ON EACH SIDE. A SECOND ROW SHOULD BE PLACED 4" FROM THE FIRST ROW IN A STAGGERED PATTERN.
- THE BOTTOM END OF BLANKET MUST BE SECURED IN A 6" X 6" TRENCH WITH A ROW OF STAPLES PLACED AT 12" INTERVALS. (DIAGRAM D)

BID ADDENDUM #2

FINAL DESIGN

REV.	DATE	REVISION DESCRIPTION	SHEET NO.
1	06/12/20	BID ADDENDUM #2	

PREPARED FOR:
 CITY OF MERIDEN
 142 EAST MAIN STREET
 MERIDEN, CT 06450

SCALE: NONE



655 Winding Brook Drive
 Glastonbury, Connecticut 06033
 860 652 8227

© 2020 BSC GROUP, INC.

ENGINEER: DMD

DATE: JUNE 18, 2020

APPROVED BY: DLS

No.

PROJECT TITLE:

KENSINGTON AVENUE CULVERT
 REPLACEMENT

TOWN:

MERIDEN

DRAWING TITLE:

STREAM BANK RESTORATION
 PLANTING NOTES & DETAILS

PROJECT NO.

83640.03

DRAWING NO.

LA-03

SHEET NO.

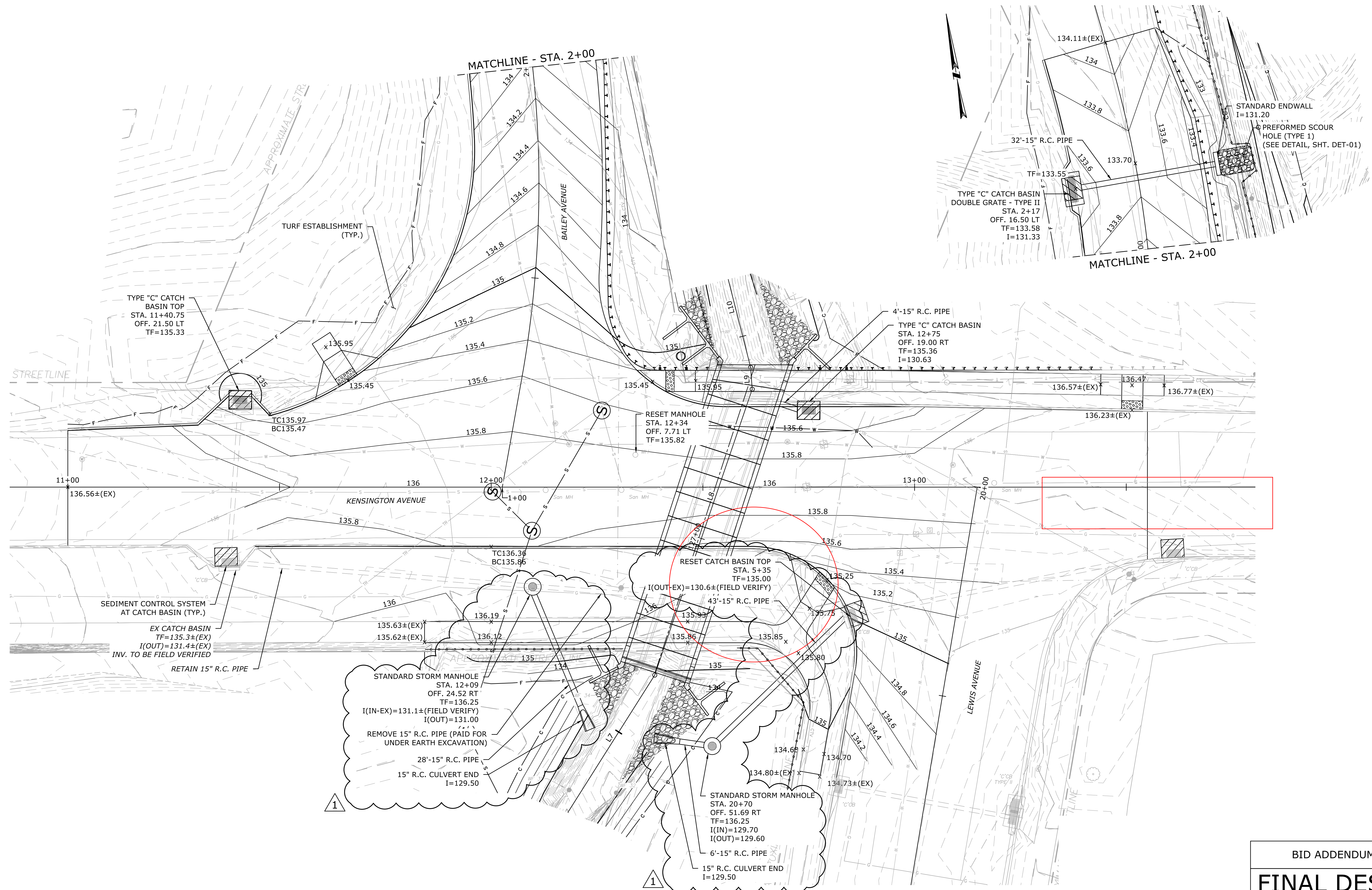

BID ADDENDUM #2
FINAL DESIGN

REV.	DATE	BID ADDENDUM #2	REVISION DESCRIPTION	SHEET NO.
1	06/12/20	BID ADDENDUM #2		

Filename: 8364003-IGP.DWG

PREPARED FOR:
 CITY OF MERIDEN
 142 EAST MAIN STREET
 MERIDEN, CT 06450

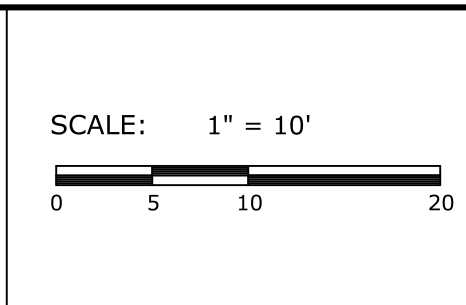

BSC GROUP
 655 Winding Brook Drive
 Glastonbury, Connecticut 06033
 860 652 8227

© 2020 BSC GROUP, INC.
 ENGINEER: DMD
 DATE: JUNE 18, 2020
 APPROVED BY: DLS

PROJECT TITLE:
**KENSINGTON AVENUE CULVERT
 REPLACEMENT**

TOWN:
 MERIDEN

DRAWING TITLE:
 INTERSECTION GRADING AND
 DRAINAGE PLAN

PROJECT NO.
 83640.03

DRAWING NO.
 IGP-01

SHEET NO.

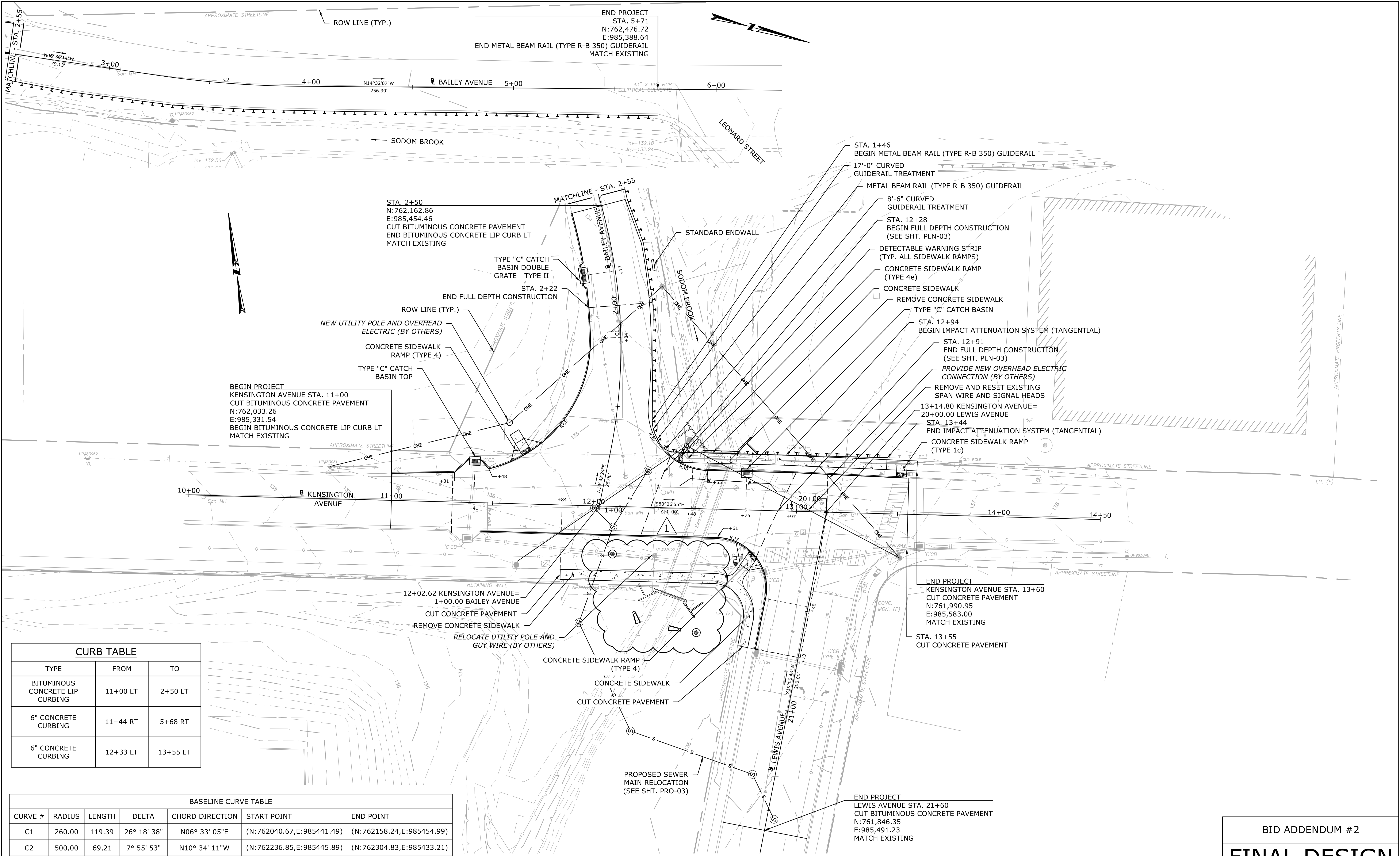

BEGIN PROJECT
 KENSINGTON AVENUE STA. 11+00
 CUT BITUMINOUS CONCRETE PAVEMENT
 N:762,033.26
 E:985,331.54
 BEGIN BITUMINOUS CONCRETE LIP CURB LT
 MATCH EXISTING

STA. 2+50
 N:762,162.86
 E:985,454.46
 CUT BITUMINOUS CONCRETE PAVEMENT
 END BITUMINOUS CONCRETE LIP CURB LT
 MATCH EXISTING

END PROJECT
 STA. 5+71
 N:762,476.72
 E:985,388.64
 END METAL BEAM RAIL (TYPE R-B 350) GUIDERAIL
 MATCH EXISTING

STA. 1+46
 BEGIN METAL BEAM RAIL (TYPE R-B 350) GUIDERAIL
 17'-0" CURVED
 GUIDERAIL TREATMENT
 METAL BEAM RAIL (TYPE R-B 350) GUIDERAIL

8'-6" CURVED
 GUIDERAIL TREATMENT

STA. 12+28
 BEGIN FULL DEPTH CONSTRUCTION
 (SEE SHT. PLN-03)

DETECTABLE WARNING STRIP
 (TYP. ALL SIDEWALK RAMP)

CONCRETE SIDEWALK RAMP
 (TYPE 4e)

CONCRETE SIDEWALK

REMOVE CONCRETE SIDEWALK
 TYPE "C" CATCH BASIN

STA. 12+94
 BEGIN IMPACT ATTENUATION SYSTEM (TANGENTIAL)

STA. 12+91
 END FULL DEPTH CONSTRUCTION
 (SEE SHT. PLN-03)

PROVIDE NEW OVERHEAD ELECTRIC
 CONNECTION (BY OTHERS)

REMOVE AND RESET EXISTING
 SPAN WIRE AND SIGNAL HEADS

13+14.80 KENSINGTON AVENUE=
 20+00.00 LEWIS AVENUE

STA. 13+44
 END IMPACT ATTENUATION SYSTEM (TANGENTIAL)

CONCRETE SIDEWALK RAMP
 (TYPE 1c)

END PROJECT
 KENSINGTON AVENUE STA. 13+60
 CUT CONCRETE PAVEMENT
 N:761,990.95
 E:985,583.00
 MATCH EXISTING

STA. 13+55
 CUT CONCRETE PAVEMENT

END PROJECT
 LEWIS AVENUE STA. 21+60
 CUT BITUMINOUS CONCRETE PAVEMENT
 N:761,846.35
 E:985,491.23
 MATCH EXISTING

CURB TABLE		
TYPE	FROM	TO
BITUMINOUS CONCRETE LIP CURBING	11+00 LT	2+50 LT
6" CONCRETE CURBING	11+44 RT	5+68 RT
6" CONCRETE CURBING	12+33 LT	13+55 LT

BASELINE CURVE TABLE						
CURVE #	RADIUS	LENGTH	DELTA	CHORD DIRECTION	START POINT	END POINT
C1	260.00	119.39	26° 18' 38"	N06° 33' 05"E	(N:762040.67,E:985441.49)	(N:762158.24,E:985454.99)
C2	500.00	69.21	7° 55' 53"	N10° 34' 11"W	(N:762236.85,E:985445.89)	(N:762304.83,E:985433.21)

WORK THIS SHEET WITH CHANNEL RESTORATION GRADING PLAN, SHT. IGP-02

BID ADDENDUM #2
FINAL DESIGN

REV.	DATE	REVISION DESCRIPTION	SHEET NO.
1	06/12/20	BID ADDENDUM #2	

Filename: 8364003-PLAN.DWG

PREPARED FOR:
 CITY OF MERIDEN
 142 EAST MAIN STREET
 MERIDEN, CT 06450

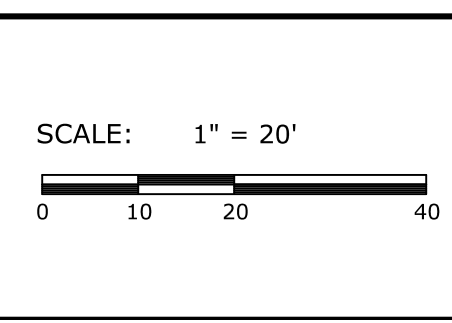

BSC GROUP
 655 Winding Brook Drive
 Glastonbury, Connecticut 06033
 860 652 8227
 © 2020 BSC GROUP, INC.
 ENGINEER: DMD
 DATE: JUNE 18, 2020
 APPROVED BY: DLS

PROJECT TITLE:
**KENSINGTON AVENUE CULVERT
 REPLACEMENT**

TOWN:
 MERIDEN
 DRAWING TITLE:
 ROADWAY PLAN

PROJECT NO.
 83640.03
 DRAWING NO.
 PLN-01
 SHEET NO.